

Thank you for Making a Difference



2018 ANNUAL REPORT

 **BAPTIST**[®]

HEALTH FOUNDATION



Crisler Boone
Executive Director

- 4 TRIPLETS!**
Mom Says Choosing Baptist Among Her “Best” Decisions
- 5 TRAVIS DUNLAP**
Grateful – After Three Close Calls
- 6 MARILYN TURNER**
Lymphedema Patient Finds Great Care and Support
- 7 BILLIE AND OSLER MOORE –**
Giving and Receiving
- 8 JEFF FINCH**
Cyclist, Turned Cancer Patient, Rides with a Purpose
- 9 Cyclists Curing Cancer**
Century Ride
- 10 Second Annual**
Hearts & Clubs
Golf Tournament
- 11 fund for the girls**
- 12 Thank you for**
- 13 2018 Donors**
- 28 Carry the Mission**
- 34 Board of Regents**
- 35 Legacy Society**
- 35 Estate & Gift Planning**
Advisory Board
- 35 MBMC Volunteers**

Cover story on page 4
Photo courtesy of Leigh Carter
Photography

Thank you for

SUPPORTING YOUR COMMUNITY

Dear Friends of Mississippi Baptist Medical Center,

On behalf of our patients, their families, and friends, thank you for the many generous gifts you shared with Baptist Health Foundation in 2018. Because you chose to invest in us, you have made an impact on the lives of those who benefit from our Christian healing ministry.

In 2018, the Baptist Health Foundation provided much-needed equipment to the hospital. Your generous gifts to our Foundation enabled us to help the tiniest of our patients by providing bassinets, Bili-Beds (special beds used to treat infants with jaundice), and infant warmers for our well baby and neonatal ICU areas. We continued our support of the Emergency Department by providing wheelchairs and beds. We funded equipment in the area of respiratory care and cardiovascular care and purchased a leading-edge Arctic Sun® cooling device that can save the lives of our patients who have had a stroke or heart attack.

Mississippi Baptist Medical Center continues to receive recognition for our excellent service and care. In 2018, two of our specialty areas were named by Healthgrades, America’s leading independent healthcare ratings organization, as one of America’s 100 Best Hospitals for Joint Replacement Surgery and Prostate Surgery. The Healthgrades designation for America’s 100 Best Hospitals represents the top 2% of hospitals nationwide. In addition, MBMC was ranked the #1 Regional Hospital in Mississippi by U.S. News and World Report. We are proud of the dedicated men and women who serve our patients every day, as their skill, compassion, and hard work are the most important elements in our success.

I hope your heart will be full, as mine was, when you read the stories of patients whose lives are better because of their time at Mississippi Baptist Medical Center – and because of the support of friends like you. Once again, thank you for your generosity and for the obvious difference you make through your gifts to Baptist.

Crisler Boone
Executive Director
Baptist Health Foundation

YOUR 2018 IMPACT

at a glance

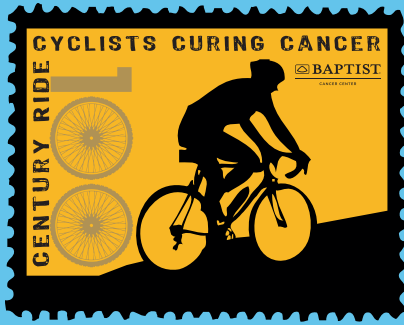

More Than **280 Riders**
100 Volunteers
50 Sponsors

Supports Cancer Navigator Efforts & Sustains Serenity Garden at Baptist Cancer Center

fund for the girls

122 Patients Assisted
124 Mammograms
30 Ultrasounds
4 Biopsies



MISSION STATEMENT

Our Mission is to assist Mississippi Baptist Medical Center in providing the highest quality health care, guided by its Christian faith, through financial support and stewardship.

VISION STATEMENT

Our Vision is to be our community's preferred health care charitable organization, recognized for extraordinary stewardship, involving all those wishing to share gifts of time, talent, and resources.

Carry the MISSION

Our Co-workers **Raised \$345,118** Including a Match from MBMC

Assisted 133 Employees

Supported 56 Local Nonprofit Organizations.



100+ Golfers and Volunteers

25 Sponsors

Helps Purchase Lifesaving Cardiovascular Equipment

Thanks to your continued support, we contributed **over \$1,000,000**

for **Advanced Technology** and **Renovations** impacting patients and guests in the following areas:

- Cardiovascular
- Oncology
- Emergency Department
- Neonatal Intensive Care Unit
- Respiratory Care
- Jackson Healthplex

TRIPLETS! MOM SAYS CHOOSING BAPTIST AMONG HER “BEST” DECISIONS

Turkey hunting suddenly became the furthest thing from his mind when Ross Hester got off the phone with his wife. For the longest time, he sat quietly, alone, in the woods trying to process the news he had just received: he and his wife were having triplets!

“Mother-to-be” Win Hester, a nurse at Bolivar Medical Center in Cleveland, Mississippi, said, “I had to take off the rest of the day when I was told!

“My uncle, who is a doctor at another hospital in Jackson, told me I should have our babies at Baptist in Jackson and recommended Dr. Meredith Travelstead as my physician. We took his advice and feel this was among the best decisions we’ve ever made!

“Originally, I was really concerned because of being a high risk pregnancy, but was assured that my doctor and hospital could handle our situation.

“We came to Jackson on a regular basis for check-ups, and, on one of the visits, Dr. Travelstead was concerned with my blood pressure. After conferring with another physician, Dr. Travelstead walked back into the exam room and said, “Okay, let’s gather the troops!” I thought she meant we should go on back to Cleveland, but that was not the case. She was ready to have these babies! We were totally caught off guard. Dr. Travelstead was troubled about my blood pressure and realized it was in everyone’s best interest to deliver right away. Things started moving quickly!”

“The entire labor and delivery process was extremely organized,” Ross said. “Each baby had his and her own team of caregivers. There were about 15 people in the delivery room — each with a specialized job. I watched as a calm just came over the room. I don’t think anyone blinked for 20 minutes!”

“I never felt stressed at all,” said Win. “Everything was very peaceful and controlled.”

The babies arrived nearly nine weeks early with the girls weighing 3.7 and 3.9 pounds, and a little boy, weighing 3.14. They stayed in the NICU for about a month.

“The staff worked hard to educate us and prepare us for going home,” Win said. “They were so awesome. It just could not have been a better experience. The girls are identical and, right now, it is very difficult to tell them apart,” she confessed. “I’m really afraid I’m going to get them mixed up!”

“We really feel very fortunate,” said Ross. “Everything went so smoothly. I can tell you I’m not going to be doing much hunting for a while,” he admitted. “I’m going to be raising babies!”

**“I never felt stressed at all,”
said Win. “Everything was very
peaceful and controlled.”**



TRAVIS DUNLAP GRATEFUL – AFTER THREE CLOSE CALLS

“You look terrible!” Travis Dunlap’s mother said when he walked into her house after she had not seen him for several weeks.

“There’s nothing like having an honest mother!” Travis laughed as the 43-year-old recalled a dramatic series of health events that began early in 2016.

“I knew I had been losing weight without trying. My feet began to swell to an extent it was hard to get my shoes on. I hadn’t been to the doctor since I was in the seventh grade, but with prodding from loved ones, I did go to an urgent care clinic where I was given an antibiotic. I got better for a while, then my feet and hands began to swell again and I became short of breath. I went to another



clinic where a blood test showed I had a high white blood count. I was referred to a hematologist who performed a series of tests. Finally, I was referred to a pulmonary specialist who became so concerned after listening to my heart that he wanted to admit me to the hospital right away. By this time, I was scared and just praying for a solution.

“When I was admitted to Baptist, we discovered I had a blood infection that had damaged my heart. I needed surgery which involved a valve replacement. The surgery brought relief – for a while.

“Two weeks later, I became short of breath again and came back to the hospital where the doctors drained a good bit of fluid from my chest.

That stabilized me, and I continued to improve.

“A few weeks later, I noticed a large lump that had begun to form on my right arm. When I went to my routine physical therapy appointment at Baptist, they looked at the lump and immediately sent me to have an ultrasound. Within 45 minutes after the ultrasound, I was in surgery!

**“I feel like I got
three chances at life!”**

“Now, I am doing just fine and know I am so blessed. I feel like I got three second chances at life!

“The doctors, nurses, therapists, assistants, and everyone at Baptist were all super. I was in the hospital so often, we got to know each other pretty well! They were really competent and compassionate, but showed me some tough love when I needed it – and I needed it a lot!

“I still go to Baptist for check-ups and enjoy seeing the people there. They saved my life! I can now run two miles and hope to start running even further.

“I am grateful for the care I got at Baptist, for my wife and son, my friends, my church and that God has given me not just a second chance, but a third chance at life. I am a blessed man!”



Photo by Kees Photography

Marilyn Turner assumed when she was finally declared “cancer free” that her health problems were over. Like so many others, she had never heard of lymphedema. Lymphedema is the swelling of one’s arms or legs due to the damage, or removal, of lymph nodes as a result of cancer treatment. This causes a blockage in the lymphatic system and prevents lymph fluid from draining properly. Marilyn was told she may have some swelling after her treatment, but it was far more swelling in her arm than she anticipated. It was painful and debilitating. Her physician referred her to Baptist’s Lymphedema Clinic – Mississippi’s only accredited Lymphedema Clinic.

“Baptist’s Lymphedema Clinic is the best ever!” Marilyn exclaimed. “They take all the time in the world to teach you how to manage your swelling. They demonstrated how to wrap my arm and told me the best material to use to wrap it. They showed me exercises I can do and were so patient working with me.

“I was given a compression sleeve at another hospital but received no instructions on how to use it. At Baptist, they guide me through everything and answer all my questions. They are great. When I walk in the door they all greet me—it’s a place that makes you feel good the minute you walk in.

**“It’s a place that makes
you feel good the minute
you walk in.”**

“The few weeks I’ve been going to the clinic, the swelling in my arm has gone down considerably. I was worried that I would have this swelling forever and not be able to do the things I enjoy doing. Now, with the help and understanding of the folks at Baptist’s Lymphedema Clinic, I feel so much better – it’s just been a real miracle to see the difference.”



Photo by Kees Photography

Life does take strange twists. In 2010, Osler Moore was featured in a Baptist Health Foundation publication as a patient of, and loyal donor to, Baptist Medical Center. Not long after the article was written, the happily-married, retired pharmacist lost his wife of 64 years.

Osler was deeply saddened by Mary Nell's death and confided that he had too much time on his hands. Attempts to keep busy by having coffee with friends and getting involved with various organizations did not seem to fill the void. On a whim, he decided to visit to his alma mater, Howard College (now called Sanford University) in Alabama, to see how it had changed since he graduated. It was there he reconnected with a former

classmate Billie Small. Billie had lost her husband around the same time Osler's wife had passed away. Billie and Osler dated for a while and, before too long, knew they were in love. They were married on Valentine's Day in 2013.

“This kind of gift helps everyone involved.”

Osler and Billie like staying very busy — which is easy under their new circumstances. Osler quickly became embraced by Billie's family and now has two children, four grandchildren and four great grandchildren. He and Billie are treasuring life — and continuing to

touch the lives of others.

After making a long series of traditional cash contributions and three gift annuities over the past 20 years, Osler and Billie wanted to give more. “We prayed about it and decided what we should do,” said Billie. “We prayed that our gift would help people, that it would make life better for others.” After careful thought, Osler and Billie chose to give another annuity — a vehicle that would help them, the hospital and those Baptist serves.

“This kind of gift helps everyone involved,” said Osler, “And, giving to Baptist is so easy. We have always had great care there, and, when we choose to give, it's very simple to do. We feel really good because we know we're helping other people.”

JEFF FINCH CYCLIST, TURNED CANCER PATIENT, RIDES WITH A PURPOSE

“...now I ride in it because I believe in a purpose bigger than myself.”



Photo by Kees Photography

“Oddly enough,” said Jeff Finch, “After riding in Cyclists Curing Cancer Century Ride for many years, I actually became a cancer patient. I turned out to be a cyclist with cancer and had a strong desire to support the hospital who helped me.”

Besides being an avid cyclist, the high-energy entrepreneur is a fitness enthusiast who has participated in many marathons, triathalons, Crossfit, and even an Ironman event. Somehow, he manages to stay fit while juggling his various businesses.

Jeff’s activities “somewhat”

slowed when he was diagnosed with cancer in 2014. Because of the physicians and other health care professionals he came to know through the Ride, he chose to be treated at Baptist.

“As I expected, the care at Baptist was great.” Jeff recalled. “I remember on my first day of treatment I received a care package assembled by a church youth group. Another cancer patient saw me with the care package and said, ‘Welcome to the club!’ I knew I was in for quite a journey and wasn’t about to have a pity party. It wasn’t easy, but I knew God was with me the entire time.

“The day after I finished my last radiation treatment and rang the gong in the Cancer Center lobby to celebrate, I rode in the 2016 Cyclists Curing Cancer Century Ride. I was determined not to miss it! My caregivers at Baptist signed the back of my biking jersey and I wore it during the 2018 ride. That was really special!

“I love to ride and Cyclists Curing Cancer means a lot to me. Of course, it’s a lot of fun, but now I ride in it because I believe in a purpose bigger than myself. Raising money for the good causes at Baptist is worth it.”

The 2018 Cyclists Curing Cancer Century Ride drew 281 riders from across Mississippi, Alabama, and Louisiana marking a successful 17th year for the Ride.

Beginning at the Clinton Healthplex, with perfectly beautiful weather, and meandering along the scenic Natchez Trace with four themed rest stops, the day concluded with ice cold chocolate milk, chilled towels, a delicious lunch, live music, door prizes, massages, and more.

Proceeds from the event went toward the Serenity Garden and Patient Navigator efforts at Baptist Cancer Center – all designed to enhance our cancer patients’ experience, as often they are going through some of the toughest times in their lives.

To the 50-plus generous sponsors and 100 enthusiastic volunteers, **THANK YOU for your support, your time, and your hard work to help make CCCR an acclaimed event for our area.**

We hope you will mark your calendars for Cyclists Curing Cancer Century Ride on September 7, 2019, and come enjoy the Ride!



MARK YOUR CALENDAR 18TH ANNUAL CYCLISTS CURING CANCER CENTURY RIDE
 Saturday, September 7, 2019 | 7:30 a.m.
 601-968-1489 | mbhs.org/cyclistscuringcancer

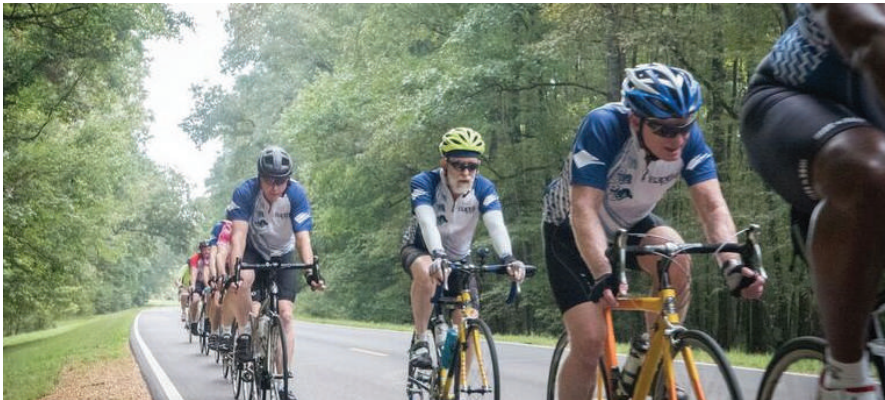



Twenty-one teams, along with countless enthusiastic volunteers, joined in support of Baptist Heart for the second annual Hearts and Clubs Golf Tournament at Annandale Golf Club on April 10, 2018. Special guest PGA Tour Player Troy Matteson played Hole #1 with every foursome. Matteson spent time with each group and gave tips to each golfer. Participants enjoyed a picture-perfect day, a delicious lunch, a post-round awards reception, and more.

A heart-felt "thank you" to all that participated!



Mississippi has one of the highest mortality rates for breast cancer in the country. That is why **fund for the girls**, Mississippi Baptist Medical Center's breast health initiative, was created. **fund for the girls** covers the cost of breast health services, such as screening and diagnostic mammograms, ultrasounds, and biopsies for Mississippians in need. **fund for the girls** focuses on early intervention and works every day to help area women detect and defeat breast cancer.

Our radiologists and Mississippi Baptist Medical Center make this initiative possible by reducing mammogram fees for these patients and the Baptist Health Foundation extends monetary assistance to cover the rest.

100% of dollars raised go directly to patient care. **We are making a difference one person at a time — one mammogram at a time.**

To learn more about how **fund for the girls** benefits the community, please visit <http://www.fundforthegirls.com>.



"**fund for the girls** brings hope to our most vulnerable, comfort to those struggling, and courage to fight another day."
Debo Dykes, 4-year breast cancer survivor



fund for the girls



Thank you for supporting your community...



BY HELPING US PURCHASE
LIFESAVING EQUIPMENT

like the Arctic Sun®

This advanced technology is a non-invasive precision temperature management system used to lower body temperature in comatose patients who have experienced Sudden Cardiac Arrest (SCA) and patients at risk of brain damage due to poor blood flow. Cooling the body by inducing hypothermia can reduce brain injury and improve neurological outcomes.

IN ADDITION, because of your support, Baptist Health Foundation was able to assist with such important capital needs as:

- Purchasing new bassinets, infant warmers, and a Bili-Bed for our Nursery
- Renovating the Cancer Center
- Refurbishing the Jackson HealthPlex
- Acquiring specialized equipment for our Clinical Laboratory
- Buying new wheelchairs and visitor chairs for the Emergency Room
- Procuring innovative new ventilators, a bronchoscope, and nerve conduction study equipment for our Respiratory Care Department

Thank you for truly making a difference

WITH YOUR GIFTS.

Thank you FOR SUPPORTING YOUR COMMUNITY

2018 DONORS *January 1, 2018 – December 31, 2018*

Baptist Health Foundation gratefully acknowledges all who supported the mission and ministry of Mississippi Baptist Medical Center in 2018.

CHAMPIONS OF GRACE (\$100,000 - \$249,999)

Carry the Mission*
Ergon Foundation, Inc.

CHAMPIONS OF MERCY (\$50,000 - \$99,999)

Anonymous
Regions Foundation
James M. Thomas and
Luvie C. Thomas Foundation*

CHAMPIONS OF LIGHT (\$10,000 - \$49,999)

Mr. and Mrs. Rick J. Calhoon**
The William H. Ellsworth Foundation*
Mr. Joseph N. Goodell*
The R. H. Green Foundation*****
Henry and Martha Hederman
Charitable Foundation*
Mississippi HomeCare*
Nucor Steel Jackson, Inc.
Sanderson Farms, Inc.***
The Walker Foundation
Drs. Becky and Chris Waterer*
Dr. and Mrs. Bob Wilkerson

HERITAGE SOCIETY (\$5,000 - \$9,999)

Baptist Memorial Health Care
Foundation
Dea Dea Baker Charitable Fund F.A.
Maggie Clark Media Services, Inc.
First Commercial Bank**
Jackson Pulmonary Associates, P.A.*
The Collin T. Lane and
Ola A. Lane Charitable Foundation
Kurt and Dianne Metzner
Charitable Fund****
Musee, LLC
Pleasant Grove Congregational
Methodist Church
The Estate of Miss Martha
Frances Sheffield

PRESIDENTS SOCIETY (\$1,000 - \$4,999)

Anonymous
American Supply Company, Inc.*
Mr. and Mrs. Chris Anderson*
BankFirst Financial Services
Baptist Memorial Hospital - DeSoto

BKD, LLP**
Blue Cross & Blue Shield of Mississippi
Foundation*
BMH Golden Triangle Auxiliary, Inc.
Crisler and Doug Boone
Cal-Maine Foods, Inc.
N.L. Carson Construction Company, Inc.
Carthage Rotary Club
The Clarion-Ledger
CommFirst Federal Credit Union
The Community Foundation
of Middle Tennessee
Crawford Investment Counsel, Inc.
Crown Health Care Laundry
Services, LLC
Dean & Dean Associates Architects, PA*
Elmer & Gladys Ferguson
Charitable Trust
First Presbyterian Day School
Gastrointestinal Associates
& Endoscopy Center, P.A.*
Mr. and Mrs. Jason S. Greener*
Hederman Brothers Printing
Melissa and Arnie Hederman
Dr. and Mrs. Robert P. Henderson
Mr. Tim Hogan
Hologic Charitable Fund
Mr. and Mrs. Skip Jernigan
Dr. Shunte Jones, Inc.
The Kroger Co.*
Mr. and Mrs. Stanley L. Kyrnerd
Leake County Baptist Association
Ms. Anne Maury Lutin
Dr. Michael D. Maples*
Methodist Rehabilitation Center*
Midsouth Elevator, LLC
Mr. and Mrs. Lee D. Miller
Mrs. Valda Miller
Mississippi Baptist Convention Board*
Mississippi Blood Services, Inc.
Mississippi College
Mississippi Hospital Association*
Mississippi Sports Medicine &
Orthopaedic Center, PLLC*
MMC Materials, Inc.
Mr. Morrison Norcross &
The Staffing Department
Mr. and Mrs. Joe W. Parker*
The Estate of James B. and
Martha Lucille McGee Parker****
Pearl High School

Mr. Quinton B. Perry
Dr. Nanette B. Pinkard
ProTel, Inc.
Mrs. Paula Pryor-Greer*
Radiological Group, PA*
Regions Wealth Management
J. Russell Rooks, MD, PLLC
Mr. and Mrs. Kurt F. Schweigert*
Mr. and Mrs. Terry Sensing
ServiceMaster OneCall
Mary and Chris Shapley*
Mr. Robert W. Shipp & The Mary
Shipp Trust Fund***
Dr. Barbie D. Sullivan*
Take One Media, LLC
Terry Service, Inc.
Miss Dorian E. Turner*
Mr. and Mrs. Thomas M. Underwood
Valic Financial Advisors, Inc.
Dr. and Mrs. Paul D. VanLandingham
Bobbie and Robert Ware*****
Watkins & Eager, PLLC
Christy and Andy Wimberly*
Julie and Dudley Wooley*
Mr. and Mrs. C. J. Wright
Mary Ellen and Larry Yarbrough***
Dr. Tammy H. Young

LOYALTY SOCIETY (\$500 - \$999)

Mr. and Mrs. Jerry Abdalla
The William C. Ashford Donor
Advised Fund
BankPlus Corporation
Baptist Hospice
Mr. and Mrs. Douglas Beard
Cabot Lodge Millsaps
Mr. and Mrs. Paul W. Calhoun*
Mr. and Mrs. Ken Causey***
CHD Management, LLC*
Mrs. Connie S. Cherry
Clark Beverage Group, Inc.
Mr. and Mrs. C. David Cleland*
Mr. Chris H. Coleman
David Young & Associates, LLC
Mr. and Mrs. Tam H. Etheridge*
Mr. and Mrs. Heath G. Ferguson
Forman, Watkins, & Krutz, LLP
Fresh Cut Catering & Floral
Mrs. Vickie B. Gerrard*****
Godwin Group, Inc.

*5-9 consecutive years

**10-14 consecutive years

***15-19 consecutive years

****20-24 consecutive years

*****25-30 consecutive years

Thank you FOR SUPPORTING YOUR COMMUNITY

Mr. Joshua Green
Hughes Eastern Corporation
Insurance & Risk Managers
Jackson Eye Associates, PLLC
Jackson Oncology Associates, PLLC***
Laura and Roy Jones****
Mr. and Mrs. David Landrum
Mascagni Wealth Management
Material Girls
Dr. and Mrs. C. Jason Miller
Miller Transportation Services, Inc.
Mississippi Baptist Medical
Center Volunteers
Mississippi Health Partners, Inc.*
Mississippi Organ Recovery Agency
Mr. and Mrs. Osler A. Moore
Northminster Baptist Church
Paul Moak Automotive, Inc.*
The Prickly Hippie
Mrs. June Reynolds*
Security Ballew, Inc.
Sheffield Rental
Southern Farm Bureau Life
Insurance Co.
The Estates of Mrs. Kate Holder Spalding
& Dr. Edward M. Holder and
The A.B. Holder Trust
Mr. and Mrs. Orland P. Stanford
Mr. and Mrs. Mike Stevens***
Mr. Ryan Swindell
Taggart, Rimes & Graham, PLLC
Suzan and J.H. Thames, Jr.
Charitable Fund*
Think VSS
UCR Properties, LLC

CENTURY SOCIETY (\$100 - \$499)

Ms. Sandra K. Acker
Ms. Katina I. Adams
Mrs. Frances R. Adcock**
Mr. Nelson M. Adcock
Ms. Christina W. Aldarondo
Ms. Dorothy W. Aldridge
Ms. Bridget N. Allen
Ms. Lynda L. Allen
Mrs. Joyce M. Allred
Mr. Justin Alsdorf
Altaworx, LLC
Ms. Judy Altman
Dr. Vinod K. Anand
Ms. Heather R. Anderson*
Ms. Brittany N. Anderton
Mr. and Mrs. David W. Arnold
Mr. and Mrs. Weldon Aultman
Ms. Valencia A. Bailey
Ms. Morgan R. Baldwin
Ms. Tonya M. Ball*

Mrs. Margaret P. Ballard
Baptist Cancer Center
Baptist Healthplex - Jackson
Baptist for Women Surgery Team
Mr. and Mrs. Terry Barlow***
Ms. Mary B. Barnett*
Ms. Ashley M. Barnette
Ms. Tyechia Bateaste*
Mr. Darrel M. Bates
Ms. Heather R. Batte*
Ms. Barbara T. Baugh
Mr. Brad A. Beattie
Mr. and Mrs. Charles E. Beauchamp, Jr.
Mr. Alon W. Bee, Jr.*
Mr. Kody C. Beech
Mr. and Mrs. Michael Bell*
Ms. Yolanda Y. Bell**
Mrs. Elizabeth F. Belz
Ms. Mary R. Bennett
Ms. Tanya R. Bennett**
Mrs. Terie L. Berry
Ms. Tanika L. Bess
Ms. Gloria G. Bilbrew*
Ms. Jamye L. Bingham
Ms. Kathy M. Blackmon*
Ms. Deborah Kay Blakeney**
Mr. Denny A. Blaylock
Ms. Kimberly R. Blumenberg
Ms. Heather M. Bounds*
Ms. Shellia A. Bournes**
Ms. Lauren K. Boutwell*
Mr. Bill Bovatsek
Mr. and Mrs. Scott Bowers
Ms. Megan Boyer
Mrs. Amy T. Boyte
Mrs. Jean T. Brewer
Ms. Brandy L. Bridges*
Ms. Christy M. Brister*
Mr. Ray Britt
Mr. James A. Broadwater*
Ms. Betty P. Brock
Mr. Glen P. Brogan*
Ms. Sue L. Brooks
Ms. Belinda C. Brown*
Brown Bottling Group, Inc.*
Ms. Michélie S. Brown
Ms. Pamerlyn D. Brown
Mr. Roy L. Brown**
Ms. Debbie Bryant***
Ms. Carleys W. Burns
Mr. Thomas A. Burns
Mr. Gary P. Bush*
CAET
Mr. Larry D. Calendar*
Ms. Amiee E. Campbell
Ms. Carolyn J. Campbell***
Ms. Charlonna A. Campbell*
Ms. Tangela M. Carlton
Mrs. Lacy M. Carpenter*
Ms. Amanda L. Carr

Ms. Josephine R. Carter*
Ms. Sherri L. Carty****
Mr. Alveno N. Castilla
Brenda and Wayne Castleberry****
Ms. Keisha K. Chaffee*
Ms. Cara Chandler
Ms. Aubrey B. Chapman
Chris Haynes Electric Supply, Inc.
Christ United Methodist Church
Mrs. Willie R. Claybrook
Mr. Marion C. Coker
Ms. Virginia J. Collins**
Mr. and Mrs. W. Owen Cook, Jr.
Ms. Cheryl A. Cooper
Mr. and Mrs. Larry K. Cordell
Ms. Linda K. Corley**
Ms. Cassandra Luell Courtney*
Ms. Catherine C. Cox
Mr. and Mrs. Ron D. Craddock
Mrs. Kristen Crawford
Ms. Sarah Crenshaw
Mrs. Levernise E. Crosby
Ms. Amy W. Cross*
Ms. Margaret Crowley
Ms. Karen E. Cumberland
Mr. Nathan Cummins
Mr. Charles Cutts
Mrs. Kathy W. Daniels*
Ms. Kelly A. Davies
Ms. Dawn Davis***
Mr. Jim R. Denson
Mrs. Faye Dickerson
Ms. Terri S. Diffy**
Mr. and Mrs. Jennings Dixon
Ms. Deborah F. Doss*
Ms. Patricia A. Dotson
Mr. and Mrs. Bob A. Dunaway*
Ms. Erica L. Dupree**
Mr. and Mrs. Thomas R. Dykes
Dr. Honey E. East
Mr. Will Easterling
Ms. Shana R. Edwards
Mr. and Mrs. Steve M. Edwards
Ms. Adelia A. Eiland
Ms. Melanie B. Eiland*
Mr. Robert R. Eiland*
Ms. Teresa Ellerbusch
Ms. Billie McGee Ellison
Mrs. Rose O. Ellmore
Ms. Anna G. Emory*
Entergy Mississippi, Inc.
Ms. Sharron Epting
Ms. April L. Ferguson
Ms. Laurie A. Ferrell***
Mr. Jeff Finch
Mrs. Bobbi J. Ford****
Mrs. Lee Ann Foreman*
Ms. Rose M. Foster*
Mrs. Janice M. Fowler*
Ms. Karin M. Fox*

Thank you FOR SUPPORTING YOUR COMMUNITY

Ms. Miranda K. Fox
 Ms. Joyce L. Franco
 Ms. Michele Fresneda
 Ms. Wren C. Fulton*
 Dr. James R. Futral, Jr.
 Ms. Mary E. Gales
 Ms. Mary Ann Gannon*
 Mr. Benjamin J. Gardner*
 Mrs. Jo Lynn Gardner***
 Ms. Bethany L. Garrison
 Mr. William D. Gassett
 Mr. Gregory Gearhart
 Ms. Tenika T. George
 Ms. Teria S. Gibbs
 Mr. Frank W. Gilchrist*****
 Mrs. Angie Gillespie
 Ms. Lisa M. Gilmer*
 Ms. Morgan Ginn
 Ms. Marilyn S. Glenn***
 Mr. Terry Glover
 Mr. and Mrs. Larry M. Godfrey
 Mr. Curtis L. Goodin*
 Ms. Sheila D. Gordon*
 Ms. Michelle M. Gray
 Mr. and Mrs. Wiley T. Greer
 Mr. Bernard V. Grewe***
 Ms. Laura K. Griffin
 Ms. Hannah M. Grissom
 Ms. Lin Gu
 Ms. Tiffany L. Gunn
 Rev. John Haeger
 Mr. Greg Hamm***
 Ms. Lisa H. Hankins
 Ms. Marisa Laine Hardin*
 Dr. and Mrs. H. Louis Harkey
 Mr. Lee W. Harrington
 Ms. Junenette R. Harris*
 Ms. Jennifer N. Hartzog*
 Ms. Adriane Harvey*
 Ms. Kristy L. Brown
 Mrs. Vera T. Hays**
 Mrs. Sally H. Hederman
 Ms. Dorothy B. Heinmiller
 Ms. Rebekah E. Henderson
 Ms. Summer A. Henderson
 Ms. Amber R. Hester*
 Mrs. Bethany B. Hill**
 Mr. Charles D. Hill*
 Ms. Kathy H. Hill
 Ms. Melissa C. Hill*
 Mr. and Mrs. Richard D. Hines***
 Ms. Brenda W. Hobson*
 Ms. Charlotte W. Hogan*
 Martha and Brad Hooey
 Ms. Patti Houston
 Ms. Virginia L. Houston
 Mr. and Mrs. Billy R. Howell, Jr.
 Ms. Brenda A. Howie*****
 Mr. Emil Hrbac, Jr.
 Mr. and Mrs. Gene Huffman***

Ms. Danielle E. Hughes
 Mrs. Tish Hughes
 Mr. and Mrs. Whit Hughes*
 Ms. Amanda H. Huitt
 Mrs. Nancy S. Huntsberry
 Mr. James G. Hutto*
 Ms. Pamela J. Hutto*
 Mr. and Mrs. Ted D. Jackson**
 Ms. Felisa S. Jacobs
 Ms. Carolyn J. Jimmerson*
 Mrs. Kelly M. Johnston*
 Ms. Karion H. Jolly
 Ms. Angela H. Jones*
 Ms. Lula Jones**
 Ms. Betty A. Keith
 Mr. and Mrs. Ted Kendall III**
 Ms. Janice L. Kersh
 Dr. and Mrs. Thomas L. Kilgore, Jr.**
 Ms. Mary Kimbrough
 Kimes & Stone Construction Co., Inc.
 Mr. and Mrs. Harry Lee Kincaid
 Kroger - Madison
 Mr. Skip Kuzel
 Lambda Zeta Chapter--Delta Sigma
 Theta Sorority Fall '87 Line
 Mr. and Mrs. Edward Lancaster
 Ms. Niccole L. Landrum
 Ms. Jamie P. Langdon*
 Mrs. Sue S. Lawrence*
 Ms. Natalie M. Lee
 Ms. Joanna H. Lewis*
 Mr. and Mrs. Rick L. Lewis*****
 Mr. Nathan C. Lingle
 Ms. Elizabeth C. Lishman*
 Mr. and Mrs. Steve Litchfield
 Mrs. Kimberly C. Little*
 Live Oak Psychological Associates, P.A.
 Ms. Delois T. Lott**
 Ms. Elizabeth C. Lovvorn*
 Ms. Michelle D. Macoy**
 Madison Healthplex
 Performance Center
 Ms. Maxine R. Magee
 Dr. and Mrs. David H. Magers***
 Ms. Shanna J. Majors
 Mrs. Leigh Ann Mallard*
 Ms. Brenda S. Malley*
 Mangia Bene, Inc.
 Ms. Rachel C. Martella***
 Mr. and Mrs. Russell L. Martin III
 Mrs. Terri C. McCarver**
 Mr. William L. McCraw
 Mr. Matthew E. McDonald
 Mr. Johnny Owen McDowell
 Ms. Fran E. McEwen
 Mrs. Lisa M. McFadden
 Mr. Anthony C. McFarland
 Mr. John S. McIntyre, Jr.
 Mr. and Mrs. Billy McKee*

Ms. Lauren B. McKee
 Ms. Victoria R. Mckenzie*
 Mrs. Jennifer L. McLain*
 Mrs. Margaret P. McLarty*
 Mrs. Judy A. McNames
 Mr. Bert McPhail***
 Mr. and Mrs. James McRae
 Mr. and Mrs. Michael M. Measells
 Ms. Trista L. Melton*
 Ms. Mitsi Meyer
 Mr. Hubert W. Miazza*
 Mr. Andrew Middleton
 Ms. Roselynn B. Middleton*
 Ms. Felecia M. Mikell*
 Mr. and Mrs. Scott F. Miller
 Mississippi Baptist Foundation*
 Mississippi Valley Title
 Insurance Company
 Mr. and Mrs. James N. Moffat III
 Mr. Paul M. Montgomery**
 Mr. and Mrs. James L. Moore
 Ms. Kimberly R. Morrison
 Ms. April N. Moses*
 Mr. David Murrell
 Mr. and Mrs. Eugene R. Naylor
 Mr. Alfred F. Newman, Jr.*
 Nix-Tann & Associates
 Mr. James Norrid
 Mrs. Jennifer K. Nunley*
 Mr. and Mrs. Tommy Oberhausen*
 Ms. Kara H. Oswalt
 Mrs. Jordan L. Owen*
 Ms. Keisha L. Pack
 Ms. Lauri R. Parker*
 Ms. Rebecca W. Parker
 Mrs. Nancy Seymour Pate
 Ms. Erica L. Payne*
 Mr. and Mrs. Howard J. Peavie
 Ms. Dana S. Peavy
 Pelican Cove Grill, LLC
 Ms. Alice F. Permenter
 Mr. Ronald D. Permenter*
 Ms. Bridgett R. Perry
 Ms. Kayla Perry
 Ms. LaDona H. Peterson*
 Ms. Arlene Denise Pettus*
 Ms. Dianna S. Phillips*
 Dr. and Mrs. Edward K. Phillips***
 Ms. Rosalyn N. Phillips*
 Mrs. Jessica Pickering
 Ms. Teresa L. Pierce*
 PILEUM Corporation
 Mr. and Mrs. David L. Ponder**
 Mrs. Sara Margaret Porter
 Prairie Farms Dairy
 Ms. Julie F. Priscock*
 Ms. Nisheka T. Purvis

Thank you FOR SUPPORTING YOUR COMMUNITY

Ms. Carolyn M. Quarles***
Mrs. Dawn Quayle**
Ms. Kristy G. Quenneville
Miss Bettye H. Quinn***
Rankin Children's Group, PLLC*
Mr. Mossie Redmond
Ms. Mary K. Reedy*
Ms. Linda J. Readus*
Mr. Justin S. Rhodes
Ms. Zianna Rhymes
Mrs. Nellie J. Rials
Ms. Carol C. Richardson***
Ms. Annie B. Ricks*
Mr. Kenneth J. Risinger
Mr. and Mrs. Jerry D. Ritter
Mr. and Mrs. Anthony A. Riviere*
Ms. Meagan M. Roberts*
Ms. Taylor B. Robinette
Mr. Chris Robinson**
Mr. Race S. Robinson*
Mrs. Flora M. Ross*
Ms. Megan A. Ruiters
Mrs. Belsy Ruiz
Mrs. Adrienne Russell
Ms. Tammy Saunders
Ms. Stephanie C. Saunders*
Mr. Herbert A. Savell, Jr.
Shamrock Global Advisors, LLC
Mr. and Mrs. Glenn D. Shaw***
Laurie and Paul E. Sheffield
Ms. Delena Shelton
Ms. Erica M. Shepard
Ms. Sarah K. Shore
Ms. Leasa K. Shorter*
Mrs. Dotti Simpson*
Ms. Diane M. Sims***
Ms. Virginia R. Sirven
Ms. Lauren M. Skinner*
Mr. and Mrs. Richard K. Slaymaker
Ms. Elizabeth J. Smith*
Ms. Giovanshia D. Smith
Ms. Janice H. Smith*
Mr. Jon David Smith
Ms. Lisa Smith*
Ms. Melanie P. Smith*
Ms. Melissa L. Smith
Mr. Micheal J. Smith
Ms. Ora J. Smith**
Southern Beverage Co.
Ms. Barbara Speights*
Mrs. Norweida R. Spencer
Ms. Penny P. Spooner*
Mr. Steve M. Stanic*
StateStreet Group, LLC
Mr. and Mrs. Steven M. Steen*
Ms. Tyronza R. Stephens
Ms. Beth F. Stevens***

Ms. Ophelia T. Stewart*
Ms. Jackie C. Stiff*
Ms. Molly E. Stillions*
Ms. Bobby J. Stokes**
Mr. and Mrs. William L. Stoltzfus*
Mr. and Mrs. Doug Stone
Ms. Leslie A. Stoufer*
Ms. Tobey Strauch
Mr. and Mrs. Larry C. Strayer***
Mr. John N. Strother*
Mr. Seth B. Stuart
Dr. and Mrs. William E. Studdard
Mr. and Mrs. Mack Sullivan
Mr. Don W. Taylor
Telos Foundation, Inc.
Ms. Jennifer A. Thaggard*
Ms. Gloria R. Thompson*
Ms. Tiara S. Thompson
Mr. William F. Thompson*
Ms. Rita M. Tierney*
Ms. Valeria B. Tillman*
Dr. A. C. Tipton, Jr.
Mr. and Mrs. James W. Touchstone
Mr. and Mrs. Ben Turbeville
Mr. and Mrs. William S. Turcotte***
Ms. Lindsey C. Turner
Mrs. Staci Tyler
Urology Associates of Mississippi
Dr. Daniel L. Venarske
Ms. Amy Vinzant
Ms. Brandi B. Wagner
Mrs. Holly L. Wagner
Mr. and Mrs. Mark Wakefield
Ms. Alberstine Walker
Mr. Andrew Walling**
Ms. Linda A. Waltman**
Ms. Brandi V. Ware*
Ms. Karen Warren
Ms. Pamela G. Washington
Mr. W. Glenn Watts*
Mrs. Barbara H. Webb
Ms. Kelly Weissinger
Ms. Courtney G. Welch*
Ms. Ashley K. Wells
Ms. Lou Ann Wells*
Ms. Kendra F. White
Ms. Karen L. Whitlow*
Ms. Katherine N. Whittington
Ms. Carolyn B. Whyte
Wier Boerner Allin Architecture, PLLC
Mrs. Carol W. Williams
Ms. Carrie J. Williams**
Ms. Jacqueline Williams
Mr. and Mrs. Terrell Duffee Williams
Mr. and Mrs. Julian B. Williamson***
Mrs. Ether R. Wilson
Ms. Linda S. Wilson*
Ms. Megan D. Wilson*
Ms. Nicole R. Winham

Ms. Deborah Wise*
Mrs. Edna M. Wolcott**
Mr. Justin M. Wyatt
Ms. Tonya S. Yancey
Ms. Rebecca A. Yarbrough*
Mrs. Sandra C. Yarbrough
Ms. Allison Young
Ms. Beverly A. Young*
Mr. David Michael Young**
Mr. and Mrs. R. James Young**
Mr. Marshall Zimmerman

PATRON SOCIETY (\$1 - \$99)

Ms. Gwen Adams
Ms. Susan D. Adams
Ms. Carolyn Adcock
Dr. and Mrs. Holland M. Addison, Jr.
Mr. William L. Addkinson, Jr.
Mr. and Mrs. S. A. Adkins
Mr. Milton Aguilar
Ms. Luma Akil
Ms. Belinda J. Alba
Mrs. Linda F. Allen
Ms. Marilyn Allen
Mr. Walter Allen
Amerigo - Ridgeland
Mr. Clifford Ammons
Mr. and Mrs. Ike A. Anderson
Mr. Scott Anderson
Ms. Sholonda R. Andrews
Ms. Susan Andrews
Ms. Claudia Anthony
Mrs. Florence Anthony
Mrs. Rose M. Anthony*
Ms. Pamela Applewhite
Ms. Jennifer J. Armon
Mrs. Rhonda B. Armstrong
Ms. Urenia Armstrong
Ms. Barbara Ashley
Mr. and Mrs. Newman E. Atkinson
Ms. June Atwood
Babalu Tacos & Tapas
Mr. Brett Bailess
Mrs. Sharon N. Bailey
Ms. Mary Ballew
Mr. Matt Ballew
Ms. Scheleria R. Banks
Ms. Ilse S. Barefoot
Mrs. Jackie Barksdale
Ms. Kimberly L. Barnes
Barrelhouse
Ms. Janet Bates
Ms. Nancy Batson
Mr. and Mrs. Chuck R. Bauerle
Mr. and Mrs. Buddy Baxter
Ms. Yvonne F. Bayne
Mr. T. W. Bearden
Ms. Eva D. Beck
Mrs. Susan P. Beckham

Thank you FOR SUPPORTING YOUR COMMUNITY

Ms. Alinda Bell
Ms. Heather F. Bell
Ms. Barbara Bentley
Ms. Barbara Benton
Mr. and Mrs. Rodger L. Bergeron
Mr. Matthew Berry
Ms. Pamela F. Berry
Mrs. Sandra Bettiga
Beulah Land Church
Biaggi's Ristorante Italiano
Ms. Maxine B. Bierbaum
Ms. Santoya S. Billbro
Ms. Renza R. Birdie
Mr. Bobby Bishop
Mr. Paul Black
Ms. Sue W. Blailock
Ms. Shannon Blanks
Mr. Ivan Blazquez
Ms. Margie P. Blue and
Ms. Barbara Parker
Ms. Rita Blunt
Ms. Jeanette Boddy
Ms. Lynette Boddy
Ms. Eugenia Boldyreva
Mrs. Bobbie K. Boleware
Ms. Emerald Bolts
Mr. John Boney
Mr. and Mrs. W. R. Boone
Mr. and Mrs. James W. Boswell
Ms. Wendy Bourdin
Mr. and Mrs. Adelbert D. Bourne
Mr. John W. Boutwell
Mr. and Mrs. Bill Bowers
Mr. Mike Boyd
Ms. Victoria Bradley
Ms. Tracy Brent
Mrs. Nancy T. Brewer
Briarwood Wine and Spirits
Ms. Lanee Bridges
Ms. Laura Bridges
Ms. Nancy Bridges
Mrs. Sheila A. Bridges
Mrs. Tammy Bridges
Ms. Courtney Brien
Mr. Brian Brister
Mr. and Mrs. Richard A. Brogdon
Ms. Rebecca C. Broome
Ms. Alberta Brown
Mr. Arthur J. Brown
Ms. Cleotha L. Brown
Ms. Iva D. Brown
Mr. J. R. Brown
Ms. Joan Brown
Ms. Kizzy N. Brown*
Mr. Lus Brown
Ms. Mae F. Brown
Ms. Marion S. Brown
Mr. Matt Brown
Ms. Winnie D. Brown
Mr. Doyle Bryan

Ms. Margaret H. Bryant
Ms. Laura Buchanan
Ms. Nancy Buchanan
Mr. Blair Buckley
Mr. Dave Bufkin
Mrs. Patricia A. Burchfield
Mrs. Earline M. Burdine
Burgers and Blues
Mr. Denny Burkes
Mr. J.B. Burkes
Ms. Alexis Burkhalter
Ms. Beverly H. Burkhalter
Mr. and Mrs. Fred Burkhalter
Mr. Hank Burns
Ms. Shumbae Burns
Mr. Dalyn Burrough
Ms. Patti Burrough
Mrs. Muriel R. Burt
Ms. Tina L. Burton
Mr. Tracy Busby
Mr. John Bush
Ms. Corinna Butler
Ms. Heather Butler
Butler Snow, LLP
Mr. and Mrs. Karl E. Byrd*
Ms. Kristie Cabunac
Mr. Travis Cain
Ms. Shannon Callahan
Mr. and Mrs. Clay Campbell
Mr. Mark Campbell
Mrs. Ruth Batton Campbell
Ms. Shundra Campbell
Ms. Elizabeth Cannon*
Ms. Geneva Cannon
Ms. Mary L. Caradine
Ms. Kellye Carlisle*
Mr. and Mrs. J. L. Carr
Mr. Michael Carroll
Ms. Betty C. Carter
Mrs. GiGi P. Carter
Mr. Samuel Carter
Ms. Michelle Cartmell
Mr. David Casey
Ms. Sarah D. Cashion
Ms. Barbara J. Catchings
Ms. Brenda Cavett
Ms. Helen L. Champion
Chapel Hill M. B. Church
Mrs. Ken Chapman
Ms. Matilda Chapman
Ms. May Chai
Mr. and Mrs. Earl L. Chastant
Dr. Alfred P. Chestnut
Mr. Dan V. Chisholm
Mr. Scott Christensen
Mrs. Fredrika Janella Christian
Ms. Debbie Christie
Mr. James E. Clark
Ms. Kim Clark

Mr. and Mrs. Monty Clark
Mr. and Mrs. W. Gray Clark*
Ms. Erica Clay
Ms. Angela L. Claybon
Mr. Fredrick Claybon
Mr. Kegan M. Claybon
Ms. Lettie Claybon
Ms. Yolanda Claybon
Ms. Geraldine Clayton
Ms. Shannon A. Cleveland
Mr. Mike Cobb
Ms. Chelle Coffee
Mr. Jim Coker
Mr. Tom Cole
Mrs. Elizabeth O. Coleman
Ms. Erma Coleman
Ms. Sharon Coleman
Mrs. Brooke Collins
Mr. Cobie Collins III
Mr. Cobie Collins, Jr.
Ms. Frances Collins
Mr. Keith Comish
Mr. Cowan Conway
Mrs. JoAnn Cook
Ms. Linda Cook
Mr. Gary Cooper
Mr. and Mrs. Scott Cooper
Mrs. Linda D. Cooper
Mr. Henry Corley
Ms. Christy Correa
Mrs. Cathy J. Cotton
Mr. and Mrs. Roy F. Cotton*
Ms. Brandy L. Courtney
Mr. and Mrs. C. Jack Covington
Mr. and Mrs. James G. Craft
Ms. Brenda Craig
Mr. and Mrs. Dennis D. Craig
Ms. Peggy Craig
Mr. James R. Cranfield
Mrs. Ernest M. Cresswell
Mr. Giles Crisler
Mr. Bunny W. Crocker
Mr. and Mrs. Jerry Crosby
Ms. Dorothy P. Crow
Mrs. Cindy Cudo
Mr. and Mrs. Joel B. Cunningham
Mr. Robert W. Cunny
Ms. Bobby Currie
Mrs. Lisa P. Dallas
Mrs. Joanne W. Darden
Ms. Mary Ann Darsey
Ms. Christy L. Davis
Mr. Dan Davis
Ms. Dawn B. Davis
Ms. Denisa B. Davis
Mr. Jarred Davis
Ms. Dottie Day

Thank you FOR SUPPORTING YOUR COMMUNITY

Ms. Karen de Kock
Mr. Don Dean
Ms. Stacy Deas
Mr. David Decareaux
Ms. Keli Lynn Deen
Ms. Wanda Delee
Mrs. Dorothy DeLoach
Ms. Jenifer W. Dendinger
Mr. Keith Dennis
Mrs. Becki DePriest
Ms. Brandi Derrick
Mr. and Mrs. Clarence E. Derrington
Mr. Brian Derry
Ms. Jennifer C. Dewolf
Mr. Andrew Dickie
Ms. Lyndsey T. Dill
Mr. John DiLorenzo*
Mr. Donald D. Dixon
Mr. Tripp Dixon
Mr. William Dixon
Mr. Thomas Dobbs
Mr. George Doby
Ms. Ebony Donelson
Mr. and Mrs. Fay C. Dong
Mr. Jeff Doremus
Ms. Carol N. Dorsey
Ms. Annie L. Doty
Mrs. Patsy P. Douglas
Ms. Stephanie S. Douglas
Mr. and Mrs. John M. Dumas
Mr. and Mrs. Charlie Dunagin
Mr. David Dunbar*
Ms. Leslie N. Dunbar
Ms. Wendy Durrell
Ms. Betty M. Dye
Mrs. Julia G. Dyess
Mr. and Mrs. Robert M. Edgar, Jr.
Ms. Amy L. Edwards
Mrs. Annie T. Edwards
Mr. Larry D. Edwards
Ms. Ashley Eggleston
Mr. and Mrs. Edward D. Eidt
Ms. Robin Elam
Mr. and Mrs. John Elliott
Mr. Craig Ellis
Ms. Edna B. Ellis
Mrs. Eva N. Ellis
Ms. Kathy Ellis
Ms. Nekesha Ellis
Ms. Semoune Ellis
Mr. Thomas M. Elzen
Ms. Cora L. Ervin
Mr. and Mrs. William Esco
Ms. Annie P. Eskridge
Mr. Chad Espeland
Mrs. Garay Esters
Mr. and Mrs. Jerry A. Estes

Ms. Christina Estrada
Mr. Ottis L. Evans
Mr. and Mrs. John W. Everly
Ms. Janet Fairchild
The Fairview Inn of Jackson
Mr. Timothy P. Farish
Mr. and Mrs. Jim O. Farrell
Mr. Bobby L. Farrell*
Mr. Claude Farris
Ms. Rebecca B. Fearn
Mr. Andre Ferrell***
Ms. Denise Ferriss
Ms. Shameka Ficklin
Mr. John Fike
Ms. Sondra R. Finkbeiner*
Mr. Haley Fisackerly, Sr.
Mr. Jerry Fisher
Mr. Charles M. Fitts, Jr.
Mr. and Mrs. Roger D. Flatt
Ms. Clara K. Flemming
Mrs. Carolyn A. Fletcher
Ms. Ruby Florence
Mrs. Jane Flowers
Mr. Michael D. Floyd*
Mr. Albert Roy Flynt
Mrs. Sheldon M. Ford
Ms. Synthia A. Foster
Mrs. Fran Fowler
Mr. Moses Fox
Mr. Dewey Franklin
Ms. Ruby M. Frazier
Ms. Cynthia Freeny
Frock Fashions
Mr. Robert E. Frost
Mrs. Ann M. Fry
Ms. Kim Fuller
Ms. Mary H. Fuller
Ms. Crystal Fuqua
Ms. Tracy C. Gaddis
Ms. Nefertiti Gaines
Mr. David Gainwell
Mr. Walter I. Gainwell
Ms. Lori D. Gale
Rev. and Mrs. Bennie Gardner
Mr. Donald W. Gardner, Sr.
Mr. and Mrs. Gregg Gardner
Ms. Lillian S. Garner
Mr. Jeff Garrett
Mrs. Margaret B. Gary
Ms. Roxanne M. Gay*
Ms. Callie Geno
Ms. Audrey R. German
Mr. Gregg Gibbes
Mr. and Mrs. David M. Gibbs
Mr. Leondrae T. Gibbs
Ms. Patricia Gibbs
Mr. Kirk Giessinger
Mrs. Renata D. Gil
Mr. and Mrs. Roger E. Gilbert

Mr. William R. Gilmore II
Ms. Jeanee Glover
Mr. and Mrs. Billy L. Gore
Ms. Anne C. Gorton
Mr. Matthew Govero
Ms. Yvonne Gower
Mrs. Judith T. Graham
Mr. Billy R. Granderson
Mr. Jerry Grantham
Ms. Cheryl Grayson
Ms. Shanica Grayson
Ms. Loretta Green
Ms. Erica L. Greenwood
Ms. Brandy Nicole Greer
Ms. Dolores H. Greer
Mrs. Muriel Greer
Ms. Tamika Greer
Mr. Matthew Greig
Ms. Jayme Griffin
Mr. Oscar Griffin
Ms. Victoria A. Griffin
Ms. Melinda Grubb
Ms. Candice M. Hagwood
Ms. Jackie Haines
Mr. Dan Halinski
Mrs. Jackie Hall
Mr. Michael Hall
Ms. Rose Hall
Ms. Thelma R. Hall
Mr. and Mrs. Toxey Hall III
Ms. Beverly Hamey
Mr. Charles A. Hamilton
Mr. Emmer J. Hammond
Mr. and Mrs. Russell E. Hampton, Jr.
Mr. Michael Hardin
Mrs. Lee Harding
Dr. Christa Hardy
Mrs. Earnestine S. Hargrove
Mr. and Mrs. Frank Harmon
Mr. and Mrs. Richard H. Harper
Ms. Ivory Harris
Mrs. Janet Y. Harris and Mr. Joe M. Hudspeth
Mr. Jimmie L. Harris
Mrs. Leah F. Harris
Ms. Nicole Harris
Ms. Sharee Harris
Mr. David Hartman*
Ms. Cynthia A. Harvey
Mr. Joshua T. Harvey
Ms. Sue Harvey
Ms. Karen Haskins
Mrs. Leslie B. Hassett
Ms. Krisha A. Hawkins
Ms. Dain Hayes
Mr. and Mrs. Jimmie L. Hayes
Ms. Rochelle Hayman
Ms. Cayla Haymer
Ms. Nicole S. Healy
Mr. Jerome Hediger
Mrs. Jennifer Heffner

Thank you FOR SUPPORTING YOUR COMMUNITY

Mr. and Mrs. Cecil F. Heidelberg III
Ms. Ann Heidke
Ms. Amanda A. Henderson
Mrs. Linda H. Henderson
Ms. Sandra Henderson
Ms. Yvette Henderson
Mr. Larry D. Hendricks
Mr. Marshall D. Hennington
Mr. James R. Henry
Mr. Joel L. Henry
Henry Wentzel's Seafood, Inc.
Mrs. Diane C. Hesselbein
Mrs. Janet Hester
Ms. Lois Hickman
Mr. and Mrs. Steve W. Hickok
Mr. Harold J. Hicks
Mr. and Mrs. G. Harry Hill
Mr. Jamie L. Hill*
Mr. and Mrs. Elbert Hilliard
Ms. Carolyn Hines
Ms. Jennifer Lee Hines
Ms. Katie M. Hines
Rev. and Mrs. Riley L. Hinton
Mr. Donald Hintz
Mr. Chris Hodge
Mrs. Jennifer Hodge
Ms. Angela L. Hoffberg**
Ms. Ebony Holden
Ms. Shelia Holden
Mrs. Marcia J. Holloway
Ms. Morgan Holloway
Mr. Hank Holman
Ms. Constance Holmes
Ms. Cheryl Hood
Mr. Thomas A. Hoover
Mr. Jason G. Horne
Ms. Pricilla Hsing
Ms. Tawanna Hudson
Ms. Karen K. Hughes*
Mrs. Lorretta W. Hulin
Mr. Alvin P. Hulse
Ms. Lynn S. Humphrey
Mrs. Dorothy S. Husbands
Mr. Otis Hutcherson
Mr. Mike Hutcheson
Ms. Kerrinton Hutton
Mr. and Mrs. Jerry Hyer
Mr. and Mrs. Harry Hyslop
IBM Corporation
Ms. Gabrielle Ingram
Mr. Joe Ingram
Ms. Ruth Irvin
Ms. Mary Israel
Mr. Abie Jackson
Ms. Anita Jackson
Mrs. Doris Christine Jackson
Ms. Janice Jackson
Mr. Justin Jackson
Ms. Kacie Jackson*
Ms. Kiva T. Jackson

Ms. Lanelle H. Jackson
Ms. Polly Jacobs
Ms. Gayla M. James
Mr. Jeff James
Mr. Matt James
Ms. Susie J. James
Ms. Elizabeth Jamo
Ms. Barbara Jeffers
Mrs. Rosie I. Jefferson
Ms. Serantha Jenkins
Ms. Michelle J. Jennings
Ms. Chennita Johnson
Ms. Claudette Johnson
Mr. Cliff Johnson
Dr. David B. Johnson
Ms. Gaynell J. Johnson
Ms. Mary Love Johnson
Brother Richard Earl Johnson
Ms. Ruth Johnson
Mr. Sullivan Johnson
Miss Vera A. Johnson
Mrs. Erin A. Johnston
Ms. Veda Johny
Mr. Braylon R. Jones
Mrs. Brenda H. Jones
Ms. Debbie W. Jones
Ms. Eula M. Jones
Mrs. Harper W. Jones
Mr. Hugh B. Jones, Jr.
Mr. Jerrion Jones
Mr. Jesse J. Jones, Jr.
Ms. Cassandra Jones
Mr. Larry B. Jones
Mrs. Marie T. Jones
Mrs. Ruby W. Jones
Dr. Sharon C. Jones
Ms. Tashayla N. Jones
Mr. Travis Jones
Mr. William Jones
Mrs. Charla M. Jordan
Dr. and Mrs. Mark R. Jourdan
Mr. Sean Keady
Ms. Nancy Jean Keith
Mrs. Nirmal K. Kelsey
Ms. Paulleana Kemp
Ms. Karol Kent
Ms. Charline Killebrew*
Ms. Juanita G. King**
Ms. Sabrina Kingston-Miles
Ms. Connie S. Knight
Ms. Dorothy Knight
Ms. Lala Knight
Mr. Michael Knight
Mr. T.K. Knight
Mr. David Knox
Dr. Carol Kossman
Mr. and Mrs. Daniel Lacey
Mrs. Eva H. Lacey
Mr. Larry Lacey

Mrs. Charlotte M. Laird
Mrs. Erica C. Lancaster
Ms. Vickie Lancaster
Dr. and Mrs. Lauren M. Lanier
Ms. Aretha Larry
Ms. Lacy C. Latham
Mr. and Mrs. Samuel B. Latham
Ms. Diane Latiker
Mr. and Mrs. Howard O. Leach
Ms. Juanita Lear
Mr. and Mrs. Jim Lee
Ms. Tammie E. Lee
Mr. Joe Leggett
Ms. Floyd Lewis
Mrs. Juanita R. Lewis
Ms. Mary F. Lewis
Ms. Queen S. Lewis
Mr. Dale Linton
Ms. Anna B. Little
Ms. Jacqueline Little
Mr. Rod Little
Mrs. Sandra E. Little
Ms. Michelle Loftin
Mr. Joseph E. Loomis
Lou's Full Serve
Ms. Justice Love
Mr. Rodney M. Love
Mrs. Sarah W. Love
Mr. Ricky Loveland
Mrs. Ann Marie Loveless
Mrs. Olivia L. Lowe
Mrs. Mary F. Loyacono*
Mr. Ricky G. Luke
Mr. and Mrs. Jimmy Luster
Lynwood Baptist Church
Ms. Brenda L. Lyons
Mr. Michael MacGown
Ms. Elizabeth MacPherson
Ms. Catosha Magee
Mr. and Mrs. Joseph A. Maggio, Jr.
Mrs. Ella Lee Mangum
Ms. Sonya M. Mangum
Mr. Robert C. Mars
Ms. Lauren Marshall
Mr. and Mrs. Burkett H. Martin
Ms. Cheryl L. Martin
Mr. John Martin
Mr. and Mrs. Ronald D. Martin
Mrs. Ruby Martin
Mr. Thomas Martin
Mrs. Toni R. Martin
Mr. Gary V. Martinelli
Mr. and Mrs. Stephen Martinolich
Ms. Nell T. Mason
Ms. Sara M. Massey
Mr. Hugh Mathis
Mr. Calvin Matthews, Jr.

Thank you FOR SUPPORTING YOUR COMMUNITY

Mr. Charles E. Matthews III
Ms. Kylie S. May
Mr. and Mrs. Jeffrey K. Mayo
Ms. Mary H. Mays
Ms. Caleigh McBride
Ms. Aimee McBroom
Ms. Ashley B. McCain
Ms. Memrie A. McCaleb
Mr. Barney D. McCann
Mr. Mike McCardle
Mrs. Marian H. McClintock
Mr. and Mrs. Billy J. McCool
Ms. Kimsey McCormick
Ms. Evelyn A. McCoy
Mr. Robert McDowell
Ms. Antoinette McGee
Mayor and Mrs. Gene McGee
Ms. Mary Helen McGee
Mrs. Sandra W. Mcgee
Mrs. Nancy C. McGhee
Mr. and Mrs. Willie E. McGowan
Dr. Bob McGuire
Ms. Angela McKenzie
Mrs. Virginia S. McKie
Mr. and Mrs. W. Thad McLaurin
Mr. and Mrs. Hugh C. McLellan
Ms. Melissa McNaul
Ms. Stacey McNeil
Mr. Dan McNerney
Ms. Kathy Merkich
Mr. Stan Merryman
Ms. Emily Metcalf
Mr. Andy Metts
Mr. and Mrs. Thomas E. Metzner
Mr. and Mrs. David L. Middleton**
Ms. Laura J. Middleton
MidSouth Engravers Plus
Ms. Candis C. Miles
Mr. Billy H. Miller
Ms. Brenda M. Miller
Mr. James Miller
Mrs. John E. Miller
Mrs. Denise Mills
Ms. Dianne Mills
Ms. Tonja D. Mills
Ms. Heather Minchew
Mississippi Children's Museum
Mississippi Symphony Orchestra
Ms. Tori Moffitt
Mr. and Mrs. Jack S. Moody
Ms. Barbara Mooney
Ms. Andrea T. Moore*
Ms. Brittany Moore
Mr. Charles Moore
Ms. Dorothy Moore
Dr. and Mrs. Jimmy L. Moore
Ms. Latrina Moore

Mr. Lloyd Moore
Mrs. Rose M. Moore
Mr. Wes Moore
Mr. Andrew Morang
Ms. Alilyah S. Morris
Ms. Mary L. Morris
Ms. Stephanie Morris
Ms. Tabbatha Morris
Mr. Wesley W. Morris
Ms. Marvis Morrison
Mr. and Mrs. David S. Morse
Mr. Waldron Mosby
Mr. and Mrs. Michael L. Moss
Mr. Bill Mundy
Mr. and Mrs. Tom Murphy
Ms. Jacquelyn Murray
Mr. and Mrs. Gregory L. Myers
Mr. Travis W. Naccarato
Ms. Quala S. Nash
Mr. Kenny Neal
Mr. Mike Neal
Mr. Robert E. Neal
Ms. Mary Nederhoed
Mr. Johnnie Ruth Neely
Mr. Shelby Neese
Ms. Ophelia G. Nelson*
Mr. Riley Nelson
Ms. Walterine Nelson
Ms. Sarah Newell
Mr. Billy D. Newman
Ms. Maurice D. Newton
Ms. Jerica L. Nichols
Mrs. Sammie C. Niles
Ms. Darlene Nix
Ms. Zandra Nowell
Mr. Brian Oakes
Ms. Bridgett Oakes
Ms. Susan O'Bryan
Mr. Jim O'Daniel
The Olive Branch
Mrs. Mary O'Quinn O'Keefe
Ms. Nancy Opshinsky
Mr. Jeremy Orr
Ms. Sarah C. Orr
Mr. Josh Osborn
Ms. Ashley M. Osorio
Mr. Lewis E. Oswald
Mr. John Owens
Ms. Mozella B. Paige
Ms. April L. Palmer
Ms. Tracy Park
Mr. and Mrs. George A. Parker
Ms. Angela Parkinson
Mr. W. E. Parks
Mrs. Barbara F. Pate
Mr. Charles T. Patterson
Mr. and Mrs. Albert Edward Paul
Mr. Steven Paulson
Ms. Susan T. Payne

Mr. Wendell Payne
Ms. Erica L. Peacock*
Mr. James A. Peden, Jr.
Mr. and Mrs. Robert L. Pee
Ms. Karen Penna
Mr. and Mrs. Johnny J. Pennington
Ms. Barbara Perry
Mr. John Peterson
Ms. Paulette Petro
Ms. Dena M. Phillips
Mr. Jeremy Phillips
Ms. Mary J. Phillips
Mr. Sidney E. Phillips
Mrs. Kathryn E. Piazza
Ms. Rosemary Pickering
Mrs. Albertstein Johnson Pickett
Ms. Dorothy Pickett
Ms. Claudia Pierags
Mr. Gene Pierce
Ms. Sarah L. Pittman
Ms. Dakota J. Pope
Mrs. Aline A. Porter
Mr. Jack Porter
Mr. Matthew Porter
Mr. and Mrs. Richard G. Porter
Mr. Evan Posey
Mr. and Mrs. Hans G. Post
Ms. Barbara Powell
Mrs. Sondra E. Powell**
Mr. Tobin Powell
Mr. Jake Presley
Mr. Scott Presley
Ms. Brenda Prewitt
Ms. Ella Price
Ms. Shenitha A. Pridgen
Ms. Tijua Priest
Mrs. Jann W. Puckett
Mr. Clarence W. Putnam
R&R Fast Food Restaurant
Dr. Whitney S. Raju
Ms. Sophie Randolph
Mr. Harry Rankin*
Mr. J. T. Ransom
Ms. Mary Rather
Rave Shine Mobile Detailing
Ms. Cynthia C. Ray
Ms. Elizabeth P. Rayner
Ms. Ana E. Recinos
Mrs. Joyce G. Redd
Ms. Donna M. Reed
Mr. Johnny B. Reed, Sr.
Ms. Julie Reed
Ms. Debra Reese
Ms. Ora M. Reese
Mr. Jason D. Reeves
Mr. Joseph J. Renaud
Mr. James Renfroe
Mr. Louis Reno
Ms. Danielle E. Reynolds
Ms. Rhonda Rhoden

Thank you FOR SUPPORTING YOUR COMMUNITY

Mr. Stephen Rials
Mrs. Renee Richard
Mr. Donzaivius Richardson
Mrs. Paulette S. Richardson
Ms. Yamina Richardson
Ms. Lucille R. Richmond
Ms. Brittany Ricker
Ms. April Riley
Ms. Jennifer P. Riley-Mahaffey
Mr. and Mrs. Fred E. Roark
Mrs. Betsy L. Robbins
Mr. and Mrs. George R. Roberson
Ms. Deborah Robertson
Ms. Joyce Robertson
Ms. Susan Robertson
Ms. Earnestine Robinson
Ms. Patricia T. Robinson
Mr. and Mrs. R. R. Robinson
Mr. Chris Rodgers
Ms. Lenora M. Rodgers
Ms. Summer J. Rodrigue
Ms. Barbara Ann Rogers
Ms. Edna H. Rogers
Ms. Lynn Rogers
Ms. Jessica Rosario
Mr. Albert K. Ross
Ms. Veronica Rouser
Mr. Luke Rowan
Mr. and Mrs. Peter B. Rowse
Ms. AuBreAnna Rucker
Ms. JaMilya Rucker
Mrs. Marguerite Rufus
Ms. Perleana H. Rufus
Ms. Carol S. Runnels
Mr. Jacob Rushing
Ms. Camille Russell
Mr. Logan Russell
Mrs. Mary D. Russell
Mrs. Bernice R. Rutledge
Mr. John R. Ryle
Mr. Rob Salley
Ms. Monica Sallie*
Sand Dollar Lifestyles*
Mr. Robert Sanders
Ms. Shameka Sanders
Mr. Leon S. Sartin III
Mr. Cletes Savell
Mr. and Mrs. David Sawaya, Jr.
Ms. Eula Saxton
Mrs. Michelle Scarbrough
Mr. Shane Scheib
Mrs. Angie M. Scott
Mr. Derick Scott
Ms. Kathy Scott
Ms. Linda Scott
Ms. Shameka Scott
Ms. Shaterica Scott
Ms. Tameka Scott
Mr. and Mrs. Wayne Scott*
Mrs. Patti Seago
Mrs. Juanita M. Seale
Ms. Carrie F. Seals
Ms. Alexandra D. Selby
Mrs. Barbara B. Sentell
Mr. and Mrs. Keith Seward
Ms. Marsha Shaw*
Ms. Sarah E. Shaw
Mr. Jason M. Shearer
Ms. Bobbie Sheffield
Ms. Gloria Sheilds
Ms. Arlene R. Shelby
Miss Barbara L. Shelby
Ms. Sharon Shelby
Ms. Thelma A. Shepherd**
Mr. Don Shepley
Ms. Melissa Sherman
Ms. Sonya M. Shupe
Mrs. Evelyn F. Sibille
Ms. Faye P. Siegel
Ms. Jennifer Sigrest
Ms. Alyssa Silberman
Mr. Scott Simpson
Mr. and Mrs. Newell Simrall IV
Mr. Ricky Sims
Mrs. Stephanie Sims
Mr. David Sinclair
Mr. and Mrs. Nolen Sistrunk
Mr. and Mrs. Thomas R. Slawson
Mrs. Elizabeth F. Sligh
Mr. Brad Smalldridge
Ms. Marjorie Smallwood
Mr. and Mrs. Arnold B. Smith
Ms. Brenda Smith
Mr. Dion Smith
Mr. D. I. Smith*
Mr. Duane L. Smith
Mrs. Emma Brooks Smith
Mr. Gary L. Smith
Ms. Grayce Smith
Mr. and Mrs. Jerry M. Smith
Mr. Kevin Smith
Ms. Lucy Smith
Mr. and Mrs. Neron Smith
Dr. Patrick O. Smith*
Ms. Rebecca Smith
Mr. Robert Smith
Mr. Ronald Smith**
Mr. and Mrs. Ruben J. Smith
Mr. and Mrs. Shelby Smith
Mrs. Shirley Ann Smith
Mr. Solon B. Smith III
Ms. Willie L. Smith
SMS Trucking
Sneaky Beans
Mr. and Mrs. James A. Snider
Dr. Somprasong Songcharoen
Mrs. Barbara C. Spann
Mr. and Mrs. John Spears
Mr. John B. Spencer III
Ms. Ethelyn D. Spiller
Ms. Kerrie Spiller
Mrs. Emma G. Spiva
Mr. and Mrs. Michal Spooner
Ms. Kathy Spratlin
Ms. Zheena Sta Maria
Mrs. Dorothy L. Staer
Ms. Nelda Lee Staton
Mr. Craig Stewart
Ms. Nannette Stewart
Ms. Mary V. Stover
Ms. Victoria M. Straughter
Mr. Jerry Stribling*
Mrs. Rene Stubbs
Ms. Fulvia Subauste
Dr. Jeanann Suggs
Ms. Brenda R. Sullivan
Ms. Rachel L. Sullivan
Ms. Stephanie S. Swilley
Ms. Margaret Swinney
Ms. Laura Tackell
Mr. and Mrs. Donald R. Tackett
Mr. Daniel E. Tate
Ms. Alisa Taylor
Mr. and Mrs. Bruce Taylor
Mr. Greg Taylor
Miss Ina Taylor*
Mrs. Jean M. Taylor
Ms. Kemba A. Taylor
Ms. Linda Ann Taylor
Mrs. Mary M. Taylor
Mr. Nathaniel Taylor
Ms. Patricia Taylor
Mrs. Susan Taylor
Mr. and Mrs. Tommy F. Taylor
Mr. Philip C. Teetson
Ms. Donna Terry
Ms. Joyce Terry
Mrs. Belinda D. Thomas
Ms. Brenda Thomas
Mr. and Mrs. S. N. Thomas II
Ms. Shelia Thomas
Ms. Velma Thomas
Mrs. Lisa Thompson
Ms. Renee Thompson
Ms. Mina Thorgeson
Ms. Ariel Thornton
Mr. Wiley C. Thornton
Ms. Shelby Thrash
Ms. Debbie Tice
Ms. De Shelia Tidewell
Mr. and Mrs. Joseph C. Tillman
Mr. and Mrs. Timothy Tillson
Ms. Shirley J. Tipton
Ms. Peggy Tisdale
Ms. Bidula Tiwary
Mrs. Willie Mae Tolbert

Thank you FOR SUPPORTING YOUR COMMUNITY

Ms. Erica S. Tornes
Mrs. Margaret M. Touchstone
Ms. Ruth P. Travis
Ms. Marshondra Trimm
Mrs. Sherry M. Tubbs
Ms. Josephine Denise Tubwell
Ms. Ana Tucker
Ms. Stephanie S. Tullos
Mrs. Betty J. Turner
Mr. Bobby L. Turner
Ms. Patticia M. Turner
Mr. and Mrs. Ralph Tutterow
Ms. Melanie E. Underwood
Ms. Bertrina L. Henry Vance*
Mr. Thomas B. Vance
Ms. Betsy Varheese
Ms. Barbara Vaughn
Ms. Teresa Veasley
Mr. Rick Venturini
Ms. Julie Vicars
Mr. Phillip P. Volland
Mr. Kenneth I. Vowell
Mrs. Cindy Walker
Ms. Janice L. Walker*
Ms. Jeanette Walker
Ms. Linda J. Wall
Mr. Cody Wallace
Ms. Francine Wallace
Ms. Ruby Wallace
Ms. Rebecca Walley*
Mrs. Ruby H. Walsh
Mr. Brian M. Waltman
Ms. Velma Walton-Shakespeare
Mr. and Mrs. Alton D. Ware
Mr. Eddy R. Warren*
Ms. Ellen Warren
Ms. Leah Warren
Ms. Linda Warren
Mrs. Lou S. Warren
Mrs. Jeanie C. Washington
Mr. George A. Watson
Ms. Ruby Weathers
Mrs. Barbara O. Weaver
Mr. John M. Weber
Mr. Patrick Webster
Ms. Holley E. Weeks
Mr. W. Scott Welch III
Mr. Andrew Wells
Ms. Audrie N. West
Ms. Mary Wheatley
Mr. Jay White
Mr. Larry White
Mr. Vernon White
Mr. Peter Whitman
Ms. Ashley N. Whitney
Ms. Judy C. Whittington
Mr. Ossie L. Whittington

Ms. Sharon Whitty
Mrs. Lynn Wiggers
Mr. Allen Williams
Mr. Arree Williams
Ms. Donna G. Williams
Ms. Jan S. Williams
Ms. Jennifer C. Williams*
Ms. Kim Y. Williams
Ms. Kimberlyn Williams
Ms. Maxine H. Williams
Ms. Patricia Williams
Ms. Rita Williams
Ms. Sanana Q. Williams
Ms. Shanequa L. Williams
Ms. Tiffany L. Williams
Ms. Tracy Williams
Ms. Carol Willingham
Ms. Sharen Willis
Ms. Wanda Jean Willis
Mrs. Jeanne M. Wilson
Ms. Theresa Wilson
Mr. Cory S. Winham
Winstead Clothing Company
Mr. Matthew J. Winstead
Ms. Virginia Faye Wittmann
Mr. Fordie Womack
Ms. Taylor J. Wonderlich
Mr. and Mrs. Jack Wood
Mr. James Wood
Mr. and Mrs. Cam Woodall
Ms. Comeka A. Woodard
Mr. L. C. Woodard
Mr. Shadrick M. Woodland
Mr. Matthew H. Woodruff
Mr. and Mrs. James E. Wooten
Mrs. Marian L. Wortman
Mr. Jack Wright
Mr. John R. Wright, Jr.
Mr. Nathan Wright
Ms. Terry Wright
Ms. Jane Yerger
Mrs. Rhoda B. Yoder
Ms. Christie Young
Ms. Narisa Young
Mr. Paul Young
Ms. Emily K. Zeigler
Ms. Miao Zhao
Ms. Mary P. Zimmerman
Ms. Gretchen R. Zito
Mr. William Zorn

IN HONOR OF:

Dr. John D. Adams, Jr.
Mr. Albert Roy Flynt
Ms. Katie M. Hines
Mr. and Mrs. Harry Lee Kincaid

Dr. Holland M. Addison, Jr.
Mr. John W. Boutwell
Mr. and Mrs. Fay C. Dong
Mr. Thomas M. Elzen
Mr. and Mrs. Scott F. Miller
Mr. and Mrs. Howard J. Peavie
Mr. and Mrs. Richard G. Porter
Ms. Perleana H. Rufus
Mr. Tommy F. Taylor
Mrs. Ruby H. Walsh

Dr. Myrna E. Alexander
Mrs. Florence Anthony

Dr. Vinod K. Anand
Mrs. Sandra E. Little
Mr. Sidney E. Phillips
Mrs. Sondra E. Powell
Mrs. Paulette S. Richardson

Chris Anderson

Brad A. Beattie
Crisler M. Boone
Brenda A. Howie
Michael D. Maples, M.D.
Justin S. Rhodes
Steve M. Stanic
Bobbie K. Ware

Dr. Joseph D. Austin
Ms. June Atwood

Ms. Amber R. Aylesworth, R.N.
Mrs. Judy A. McNames

Dr. Philip A. Azordegan
Mrs. Nancy C. McGhee

Dr. Abdul G. Bahro
Mr. Larry B. Jones

Dr. Justin T. Baker
Mr. and Mrs. Douglas Beard
Mr. Charles Cutts
Ms. Katie M. Hines
Mr. and Mrs. Scott F. Miller
Mr. and Mrs. C. J. Wright

Dr. Eric Lee Balfour
Mrs. Earline M. Burdine

**Baptist Cancer Center -
Techs and Nurses**
Mrs. Holly L. Wagner

Baptist Heart Valve Clinic
Dr. Robert P. Henderson

Dr. Bret J. Barrett
Mr. and Mrs. Buddy Baxter

Dr. Robert Battle
Mrs. Jean M. Taylor

Thank you FOR SUPPORTING YOUR COMMUNITY

Mr. Brad A. Beattie

Chris Anderson
Crisler M. Boone
Brenda A. Howie
Michael D. Maples, M.D.
Justin S. Rhodes
Steve M. Stanic
Bobbie K. Ware

Dr. John A. Bellan

Mr. Adelbert D. Bourne
Mr. and Mrs. Edward D. Eidt
Mr. Charles M. Fitts, Jr.

Dr. J. Michael Bensler

Mrs. Margaret P. Ballard
Mr. Darrel M. Bates
Mr. and Mrs. Harry Lee Kincaid
Mr. Dale Linton
Mrs. Patricia L. Maggio

Ms. Jennifer S. Berry, R. N.

Mr. Dan V. Chisholm

Dr. Scott M. Berry

Mrs. Jackie Hall
Mrs. Earnestine S. Hargrove
Ms. Laura J. Middleton
Ms. Alice F. Permenter

Dr. Bruce T. Black

Mr. and Mrs. G. Harry Hill
Mrs. Shirley Ann Smith

Dr. Kendall T. Blake

Mrs. Bernice R. Rutledge

Crisler M. Boone

Chris Anderson
Brad A. Beattie
Brenda A. Howie
Michael D. Maples, M.D.
Mr. and Mrs. James N. Moffat III
Justin S. Rhodes
Steve M. Stanic
Bobbie K. Ware

Crisler M. Boone and Family

Barbara H. Webb

Dr. Donald P. Brannan

Mrs. Marguerite Rufus

Dr. David Bridgers

Ms. Jane Yerger

Ms. Robin Brown

Mr. Morrison Norcross and
The Staffing Department

Dr. Walter M. Burnett

Ms. Nancy Jean Keith

Dr. Jamey W. Burrow

Mr. and Mrs. Buddy Baxter
Ms. Fran E. McEwen

Dr. Michael R. Byers

Mr. and Mrs. Gregory L. Myers
Mrs. Jeanne M. Wilson

Mr. Rick J. Calhoon

Crisler M. Boone
Mr. and Mrs. Whit Hughes
Bobbie K. Ware

Dr. Graham C. Calvert

Mrs. Brenda J. Castleberry
Ms. Ethelyn D. Spiller

Dr. Nancy L. Campbell

Mr. and Mrs. Larry K. Cordell
Ms. Betty M. Dye
Mrs. Ruby W. Jones
Mrs. Patricia T. Martin
Mrs. Judy A. McNames
Mrs. Mary O'Quinn O'Keefe
Mr. and Mrs. Robert L. Pee
Mrs. Flora H. Pennington
Mrs. Kathryn E. Piazza
Mr. Clarence W. Putnam
Ms. Elizabeth P. Rayner
Mrs. Paulette S. Richardson
Mr. John B. Spencer III
Mrs. Mary M. Taylor
Ms. Jeanette Walker
Mr. George A. Watson

Dr. D. Tim Cannon

Mr. and Mrs. Richard H. Harper
Mrs. Patricia Hinton

Dr. William B. Castle

Mrs. Rosie I. Jefferson
Ms. Fran E. McEwen
Mr. W. Scott Welch III

Dr. Angela L. Chandler

Mrs. Elizabeth O. Coleman
Mr. and Mrs. Gregory L. Myers
Dr. A. C. Tipton, Jr.

Dr. Timothy Chin-Yu Chen

Mrs. Ruby Martin

Dr. Gary A. Cirilli

Ms. Alice F. Permenter

Dr. Todd A. Clayton

Mr. and Mrs. Bob R. Flowers
Mr. and Mrs. Jerry Hyer
Mr. Leon S. Sartin III and Mrs. Ozemblem Sartin
Mr. and Mrs. Alton D. Ware

Dr. Nicole D. Cleveland

Mr. Larry B. Jones

Mrs. Kellie M. Cook

Dr. and Mrs. Bob Wilkerson

Dr. G. Edward Copeland

Ms. Susie J. James

Dr. John J. Corley

Mr. Edward D. Eidt

Ms. Meredith H. Covington, CFNP

Mr. and Mrs. Scott F. Miller
Mrs. Marian L. Wortman

Dr. Jason Craft

Mr. Bobby Bishop

Dr. J. Holt Crews

Ms. Mary Helen McGee

Dr. John L. Cross

Mr. Bobby Bishop

Dr. Patrick P. Daily

Mr. Billy D. Newman
Ms. Alice F. Permenter

Dr. Scott Davis

Mrs. Nancy T. Brewer
Mrs. Elizabeth O. Coleman

Ms. Tammy S. Davis, PA

Mr. Johnny Owen McDowell

Dr. Bart DeLashmet, Jr.

Mr. Denny A. Blaylock
Mr. Charles M. Fitts, Jr.
Mr. and Mrs. Wiley T. Greer
Mr. Emil Hrbac, Jr.
Mr. and Mrs. Ralph Tutterow
Mrs. Marian L. Wortman

Dr. Renee O. Dyess

Mr. Jim R. Denson
Mrs. Eva N. Ellis

Dr. Jesse C. Ethridge

Mr. and Mrs. Douglas Beard

Dr. Alfredo H. Figueroa

Mr. Dan V. Chisholm
Mr. and Mrs. Scott Cooper
Mr. and Mrs. Roy F. Cotton
Mrs. Judith T. Graham
Mrs. Cora Jean Miller

Dr. David Flemming

Ms. Carleys W. Burns
Mr. and Mrs. Samuel B. Latham
Ms. Nell T. Mason
Mr. and Mrs. Jerry D. Ritter

Lee Ann Foreman

Chris Anderson
Brad A. Beattie
Crisler M. Boone
Brenda A. Howie
Michael D. Maples, M.D.
Justin S. Rhodes
Steve M. Stanic
Bobbie K. Ware

Mr. Scott French, FNP

Mrs. Lee Harding

Dr. Richard B. Friedman

Mr. and Mrs. Douglas Beard
Mr. Charles Cutts
Mr. and Mrs. Jennings Dixon
Mr. W. E. Parks
Mrs. Holly L. Wagner

Dr. F. Earl Fyke III

Ms. Maurice D. Newton

Dr. Eric Gavour

Ms. Carol N. Dorsey

Thank you FOR SUPPORTING YOUR COMMUNITY

Dr. Leland D. Gebhart III

Mrs. Karon Hall

Dr. Don A. Gibson

Mrs. Linda H. Henderson

Ms. Mary Gordy, CFNP

Mrs. Judith T. Graham

Mr. R. R. Robinson

Dr. Raymond F. Grenfell III

Mr. S. A. Adkins

Dr. James C. Griffin, Jr.

Ms. Mary J. Phillips

Ms. Mary Lou Haeger

Rev. and Mrs. John Haeger

Dr. Alex Haick

Mrs. Jane Flowers

Ms. Faye P. Siegel

Ms. Nelda Lee Staton

Dr. Charles E. Hall

Mr. J. R. Brown

Mr. Emil Hrbac, Jr.

Dr. James Hamilton IV

Mrs. Rose O. Ellmore

Ms. Amy Hancock, CFNP

Mrs. Bernice R. Rutledge

Dr. Randy Hankins

Mr. Larry B. Jones

Dr. Neil Haraway

Mrs. Carolyn A. Fletcher

Ms. Mary H. Fuller

Mrs. Sarah W. Love

Mrs. Nancy C. McGhee

Dr. Bill Harper

Mr. Billy L. Gore

Leah F. Harris

Chris Anderson

Brad A. Beattie

Crisler M. Boone

Brenda A. Howie

Michael D. Maples, M.D.

Justin S. Rhodes

Steve M. Stanic

Bobbie K. Ware

Dr. William J. Harris III

Mr. Darrel M. Bates

Mr. Bob A. Dunaway

Mr. Dale Linton

Dr. W. Keith Harris

Ms. Rebecca C. Broome

Mr. Barney D. McCann

Mr. and Mrs. Neron Smith

Mrs. Rhoda B. Yoder

Mr. and Mrs. Charles Haywood

Mr. and Mrs. Joe W. Parker

Dr. Massie H. Headley

Mr. Gary Cooper

Mrs. Cora Jean Miller

Dr. Gina E. Heath

Mr. Johnny Owen McDowell

Mr. Charles D. Herrington, PT

Mr. and Mrs. Howard J. Peavie

Mrs. Betty Jo Hewitt

Mr. and Mrs. Charlie Dunagin

Dr. Steve Hindman

Mr. Dewey Franklin

Mr. and Mrs. Albert Edward Paul

Dr. E. Rhettson Hobgood

Rev. and Mrs. Riley L. Hinton

Ms. Donna Hodges, CFNP

Mr. and Mrs. Daniel Lacey

Dr. Reed B. Hogan III

Ms. Anne Maury Lutin

Dr. Michael S. Hogue

Mr. and Mrs. James W. Boswell

Ms. Mae F. Brown

Dr. Alfred P. Chestnut

Mr. Dan V. Chisholm

Mr. and Mrs. Clarence E. Derrington

Ms. Chennita Johnson

Mrs. Olivia R. Lowe

Mr. Albert K. Ross

Mrs. Norweida R. Spencer

Martha Hooey

Crisler M. Boone

Dr. W. Stewart Horsley

Mr. R. R. Robinson

Mrs. Betty J. Turner

Dr. Jatinder P. Hothi

Ms. Mary E. Gales

Dr. Gerry Ann Houston

Larry and Mary Ellen Yarbrough

Ms. Brenda A. Howie

Chris Anderson

Brad A. Beattie

Crisler M. Boone

Michael D. Maples, M.D.

Justin S. Rhodes

Steve M. Stanic

Bobbie K. Ware

Dr. J. Kevin Ingram

Mrs. Joyce M. Allred

Dr. Bard Johnston

Mr. Ossie L. Whittington

Dr. James S. Jones

Ms. Dolores H. Greer

Laura L. Jones

Crisler M. Boone

Dr. Les Jones

Mr. and Mrs. G. Harry Hill

Dr. T. Matthew Jones

Mrs. JoAnne W. Darden

Dr. W. Hampton Jones III

Mr. Billy L. Gore

Ms. Dain Hayes

Mrs. Sandra C. Yarbrough

Dr. Scott Kelly

Mr. Gregory L. Myers

Dr. Ayesha Khalid

Mr. W. Owen Cook, Jr.

Dr. Kevin A. Kosek

Ms. Anne Maury Lutin

Dr. Ronald P. Kotfila

Mrs. Paulette S. Richardson

Dr. Albert M. Koury

Mrs. Sherry M. Tubbs

Dr. Todd Lawson

Mr. James R. Cranfield

Mr. Bob A. Dunaway

Mrs. Linda H. Henderson

Mr. Dale Linton

Mrs. Ann Marie Loveless

Mr. and Mrs. Fred E. Roark

Mr. Albert K. Ross

Dr. Jeffrey LeDuff

Mr. and Mrs. Jennings Dixon

Ms. Carol N. Dorsey

Mrs. Annie T. Edwards

Mr. and Mrs. Jimmie L. Hayes

Dr. Phillip B. Ley

Mrs. Leslie B. Hassett

Dr. Michael C. Livingston

Mrs. Rosie I. Jefferson

Dr. Andrew C. Mallette

Mr. and Mrs. Wiley T. Greer

Ms. Ethelyn D. Spiller

Dr. Robert A. Mallette

Mrs. Muriel R. Burt

Dr. Michael D. Maples

Chris Anderson

Brad A. Beattie

Crisler M. Boone

Brenda A. Howie

Whit Hughes

Justin S. Rhodes

Steve M. Stanic

Bobbie K. Ware

Dr. Murphy S. Martin

Mr. James R. Henry

Dr. Robert Vonn McGee

Mr. and Mrs. Richard H. Harper

Mrs. Mildred H. McHenry

Mr. and Mrs. Steve Litchfield

Dr. Obie M. McNair

Mrs. Florence Anthony

Dr. John H. McVey

Ms. Betty M. Dye

Mrs. Mary O'Quinn O'Keefe

Dr. R. Kerk Mehrle

Mrs. Earline M. Burdine

Ms. Janet Fairchild

Mrs. Dianne K. Metzner

Mr. and Mrs. Thomas E. Metzner

Thank you FOR SUPPORTING YOUR COMMUNITY

Dr. John B. Milam

Mr. and Mrs. Michael L. Moss

Dr. John M. Miller

Ms. Mary E. Gales

Mississippi Baptist Medical Center Staff

Mrs. Marie T. Jones

Mr. J. T. Ransom

Dr. Joseph B. Montgomery

Mr. Billy L. Gore

Dr. Bufkin Moore

Ms. Alice F. Permenter

Dr. James L. Moore

Ms. Eva D. Beck

Ms. Winnie D. Brown

Ms. Mary L. Caradine

Ms. Mary H. Fuller

Mrs. Juanita R. Lewis

Mrs. Olivia R. Lowe

Ms. Mary H. Mays

Mr. and Mrs. Robert L. Pee

Mr. Quinton B. Perry

Nellie J. Rials, Lisa Jackson,

and Melissa Henderson

Mrs. Patti Seago

Mr. and Mrs. Arnold B. Smith

Ms. Rachel L. Sullivan

Mrs. Virginia Williams

Mrs. Tay Morgan

Mrs. Finney Moore

Dr. Michael M. Morgan

Mr. W. Owen Cook, Jr.

Mrs. Retha L. Moss

Mr. and Mrs. Chris Anderson

Dr. Jason G. Murphy

Mr. and Mrs. J. L. Carr

Mr. Jim R. Denson

Mr. Whit Hughes

Dr. Sharon C. Jones

Mrs. Ella Lee Mangum

Ms. Sarah L. Pittman

Mrs. Jann W. Puckett

Mrs. Dorothy L. Staer

Dr. Bob Myers

Mr. Johnny B. Reed, Sr.

Dr. Martin M. Newcomb

Dr. A. C. Tipton, Jr.

Dr. Lee Nicols

Ms. Mary H. Fuller

Mr. Charles A. Hamilton

Ms. Bobbie Sheffield

Mrs. Norweida R. Spencer

Mrs. Erin Nobles

Albertstein Johnson-Pickett

Dr. Christy L. Nohra

Ms. Betty C. Carter

Ms. Lois Hickman

Ms. Jane Oakes

Mr. and Mrs. Edward Lancaster

Dr. Laura P. Parks

Ms. Ethelyn D. Spiller

Dr. Samuel H. Peeples

Ms. Cleotha L. Brown

Ms. Beverly H. Burkhalter

Dr. Alfred P. Chestnut

Mr. Bob A. Dunaway

Ms. Ruby M. Frazier

Ms. Lanelle H. Jackson

Ms. Barbara Ann Rogers

Mrs. Barbara C. Spann

Ms. Myra Penn

Dr. and Mrs. Bob Wilkerson

Dr. Doug Perry

Mr. and Mrs. Ray Britt

Dr. Anthony B. Petro

Mrs. Elizabeth F. Belz

Mr. Alton D. Ware

Dr. Denise E. Phillips

Mrs. Jean M. Taylor

Dr. Jana W. Phillips

Mrs. Julia G. Dyess

Mrs. Lorretta W. Hulin

Dr. Trevor R. Pickering

Ms. Cleotha L. Brown

Mrs. Linda D. Cooper

Mrs. Betsy H. Farrell

Mrs. Brenda H. Jones

Mrs. Dorothy L. Staer

Dr. John R. Pieklik

Mrs. Norweida R. Spencer

Dr. David C. Pierre

Ms. Mary E. Gales

Meredith Pittman

Crisler M. Boone

Dr. Raymond L. Portis

Mrs. Carol P. Harper

Dr. Gerald P. Randle

Mrs. Linda H. Henderson

Dr. Maria G. Rappai

Mrs. Patsy P. Douglas

Mr. Charles A. Hamilton

Shari Reinhardt

Crisler M. Boone

Mr. Justin S. Rhodes

Chris Anderson

Brad A. Beattie

Crisler M. Boone

Brenda A. Howie

Michael D. Maples, M.D.

Steve M. Stanic

Bobbie K. Ware

Rev. & Mrs. David A. Rich

Mr. and Mrs. R. James Young

Dr. David Richardson

Mr. William L. Addkinson, Jr.

Mrs. Christine P. Rodgers

Mr. and Mrs. Howard J. Peavie

Dr. Russell Rooks

Mrs. Nancy C. McGhee

Dr. Joe R. Ross, Jr.

Dr. Alfred P. Chestnut

Mr. Owen Cook, Jr.

Mr. Charles M. Fitts, Jr.

Mr. Johnny B. Reed, Sr.

Mr. Terrell Duffee Williams

Dr. John M. Runnels

Mr. and Mrs. William Esco

Dr. L. F. Sams III

Mr. and Mrs. Scott Cooper

Mr. Donald D. Dixon

Mrs. Ella Lee Mangum

Mr. Alfred F. Newman, Jr.

Dr. Sara S. Sanders

Mr. Dewey Franklin

Dr. Shawn Sanders

Mrs. Margaret P. Ballard

Mr. Hugh B. Jones, Jr.

Ms. Maurice D. Newton

Michelle Scarbrough

Crisler M. Boone

Dr. Roderick A. Shields

Ms. Mary Helen McGee

Dr. Neal I. Shparago

Mr. and Mrs. Jerry Hyer

Dr. Grace G. Shumaker

Mrs. Elizabeth F. Belz

Mrs. Terie L. Berry

Mr. and Mrs. Ray Britt

Mrs. Ernest M. Cresswell

Mr. and Mrs. Jennings Dixon

Mrs. Rose O. Ellmore

Mrs. Margaret M. Touchstone

Mrs. Ruby H. Walsh

Dr. Taylor F. Smith

Mrs. Mary O'Quinn O'Keefe

Mr. and Mrs. Howard J. Peavie

Mrs. Ruby H. Walsh

Dr. James Q. Sones II

Mr. and Mrs. Albert Edward Paul

Dr. Steven Speights

Mrs. Terie L. Berry

Mrs. Linda J. Womack

Steve M. Stanic

Chris Anderson

Brad A. Beattie

Crisler M. Boone

Brenda A. Howie

Michael D. Maples, M.D.

Justin S. Rhodes

Bobbie K. Ware

Thank you FOR SUPPORTING YOUR COMMUNITY

Dr. David R. Steckler

Dr. Sharon C. Jones

Dr. William D. Stephens

Mrs. Jean Adkins
Mr. and Mrs. Adelbert D. Bourne
Mr. and Mrs. Ray Britt
Ms. Chennita Johnson
Mr. and Mrs. Daniel Lacey
Mrs. Mary D. Russell
Mrs. Evelyn F. Sibille
Mr. Phillip C. Teetson
Mr. Phillip P. Volland
Mr. and Mrs. Mark Wakefield
Ms. Jeanette Walker

Mike K. Stevens

Chris Anderson
Brad A. Beattie
Crisler M. Boone
Brenda A. Howie
Michael D. Maples, M.D.
Justin S. Rhodes
Steve M. Stanic
Bobbie K. Ware

Dr. Lynn Stringer

Mr. Billy D. Newman

Dr. Jeanann Suggs

Mr. Dan V. Chisholm

Dr. Barbie D. Sullivan

Mrs. Rose O. Ellmore
Mrs. Evelyn F. Sibille

Ina Taylor

Crisler M. Boone

William F. Thompson

Chris Anderson
Brad A. Beattie
Crisler M. Boone
Brenda A. Howie
Michael D. Maples, M.D.
Justin S. Rhodes
Steve M. Stanic
Bobbie K. Ware

Dr. William P. Thompson

Mr. and Mrs. G. Harry Hill
Mrs. Bernice R. Rutledge

Dr. Keith D. Thorne

Mr. Joseph E. Loomis
Mr. Barney D. McCann
Ms. Maurice D. Newton

Dr. Meredith M. Travelstead

Mrs. Sarah W. Love
Ms. Alice F. Permenter
Mrs. Carolyn B. Smith

Dr. Lauren B. Treadwell

Ms. Anne Maury Lutin

Dr. Paul D. VanLandingham

Mr. and Mrs. Buddy Baxter
Mr. J. R. Brown
Ms. Kathy Ellis
Mr. Hank Holman
Mr. and Mrs. Harry Hyslop
Mrs. Marie T. Jones
Mr. and Mrs. Howard O. Leach
Mrs. Sammie C. Niles
Mr. and Mrs. Johnny J. Pennington
Ms. Lenora M. Rodgers
Mrs. Marguerite Rufus
Mr. and Mrs. Fordie Womack

Dr. C. Randy Voyles

Mr. J. R. Brown

Dr. Joyce Wade-Hamme

Ms. Arlene R. Shelby

Dr. David A. Wahl

Mrs. Elizabeth F. Belz
Mrs. Emma G. Spiva

Ms. Anna D. Walley, FNP

Mrs. Willie Mae Tolbert

Bobbie K. Ware

Chris Anderson
Brad A. Beattie
Crisler M. Boone
Brenda A. Howie
Michael D. Maples, M.D.
Justin S. Rhodes
Steve M. Stanic

Dr. James L. Warnock

Mr. Ike A. Anderson
Mrs. Patsy P. Douglas
Mrs. Leslie B. Hassett
Mr. Wesley W. Morris
Mr. and Mrs. Ralph Tutterow

Dr. H. Chris Waterer

Mrs. Joyce M. Allred
Mrs. Faye Dickerson
Mr. Emil Hrbac, Jr.
Mrs. Marie T. Jones
Mrs. Patricia T. Martin
Mr. William L. McCraw and Family
Mr. and Mrs. R. R. Robinson
Ms. Delena Shelton
Mrs. Betty J. Turner

Dr. Richard E. Weddle

Mr. and Mrs. Jeffrey K. Mayo
Mr. Billy D. Newman

Dr. E. Stephens Weeks, Jr.

Mrs. Ella Lee Mangum

Dr. David O. Westbrook

Mrs. Lisa M. McFadden

Dr. Curtis D. Whittington, Jr.

Dr. A. C. Tipton, Jr.
Mr. and Mrs. Mark Wakefield

Dr. Thomas L. Wiley, Jr.

Mrs. Jean M. Taylor
Mrs. Carolyn Wakefield

Dr. Bob Wilkerson

Mrs. Lorretta W. Hulin
Dr. Sharon C. Jones
Mr. and Mrs. Michael L. Moss
Mr. and Mrs. Keith Seward
Ms. Nelda Lee Staton
Mrs. Sherry M. Tubbs

Dr. Jane-Claire B. Williams

Ms. Ilse S. Barefoot

Dr. William T. Williams

Mrs. Flora H. Pennington
Ms. Jeanette Walker
Mr. Alton D. Ware

Dudley D. Wooley

Crisler M. Boone

Dr. John R. Wooley

Mrs. Juanita M. Seale
Mrs. Mary M. Taylor
Julie and Dudley Wooley

Dr. Douglas L. Yeager

Mr. and Mrs. Mac McClintock

Dr. Tammy H. Young

Mr. David W. Arnold
Mr. Bobby Bishop
Mrs. Earline M. Burdine
Ms. Mary L. Caradine
Mr. Charles Cutts
Mrs. Patsy P. Douglas
Mrs. Jane Flowers
Mr. James R. Henry
Mrs. Ella Lee Mangum
Margaret P. McLarty
Mr. and Mrs. Robert L. Pee
Ms. Alice F. Permenter
Mr. and Mrs. Jerry D. Ritter
Mrs. Holly L. Wagner

IN MEMORY OF:**Mr. James T. Ballard**

Dr. Nanette B. Pinkard

Mrs. Vaiden Barlow

Ms. Billie McGee Ellison

Ms. Kathryn J. Bearden

Mr. T. W. Bearden
Ms. Maxine B. Bierbaum
Mr. and Mrs. Clay Campbell
Mr. and Mrs. James E. Clark
Mr. and Mrs. C. Jack Covington
Mr. and Mrs. Ron D. Craddock
Ms. Wanda Delee
Mr. and Mrs. Charlie Dunagin
Mr. and Mrs. Rodney Dykes
Dr. and Mrs. Lauren M. Lanier
Ms. Lucille R. Richmond
Mr. and Mrs. Steve Warren

Mr. Carl N Bishop

Mrs. Lynn Wiggers

Thank you FOR SUPPORTING YOUR COMMUNITY

Mrs. Ginny Bryant

Dr. Whitney S. Raju

Mrs. Mary Ann Burkes

Mr. J.B. Burkes

Ms. Gina Carter-Simmers

Dr. Christa Hardy

Ms. Katryna Kinn and Lambda Zeta Chapter--
Delta Sigma Theta Sorority Fall '87 Line

Mr. Herbert L. Coleman

Mr. and Mrs. Rick J. Calhoon

Mr. Joel Robert Converse

Mr. and Mrs. Michael M. Measells

Mr. and Mrs. Kurt F. Schweigert

Mr. Chet Cox

Mr. and Mrs. Edward Lancaster

Mrs. Jewel M. Davis

Bobbie K. Ware

Dr. James C. Griffin, Jr.

Baptist for Women Surgery Team

Ms. Joyce L. Franco

Mrs. Brenda S. Haddon

Mrs. Dorothy S. Husbands

Mrs. Peggy F Hennington

Mr. Marshall D. Hennington

Mrs. Tanya C. House

Mr. Nathan Cummins

Mrs. Becki DePriest

Mr. and Mrs. John Elliott

Mrs. Margaret B. Gary

Hughes Eastern Corporation

Lynwood Baptist Church

Mr. and Mrs. Burkett H. Martin

Mr. and Mrs. John Spears

Mr. and Mrs. Doug Stone

Mr. and Mrs. Donald R. Tackett

Ms. Shirley J. Tipton

Ms. Judy C. Whittington and Family

Ava Joyce Johnson

Mrs. Jessica Pickering

Dr. Brian P. Johnson

Mrs. Patricia A. Burchfield

Mr. and Mrs. Peter B. Rowse

Mr. John W. Jones

Mrs. Marie T. Jones

Mr. P. S. Kelsey

Mrs. Nirmal K. Kelsey

Mr. John S. "Bo" King

Paul E. and Laurie Sheffield

Mrs. Dorothy L. Lampton

Crisler and Doug Boone

Mrs. Sally H. Hederman

Mr. Leslie B. Lampton, Sr.

Crisler and Doug Boone

Mr. and Mrs. Rick J. Calhoon

Mrs. Sally H. Hederman and

Blair and Doug Hederman

Mrs. Lillie R. Lowe

Ms. Margaret Swinney

Mrs. Dan Ellen Maples

Crisler and Doug Boone

Mr. and Mrs. W. R. Boone

Ms. Betty P. Brock

Butler Snow LLP

Mr. and Mrs. Rick J. Calhoon

Mr. and Mrs. Dennis D. Craig

Ms. Margaret Crowley

Mr. and Mrs. Steve M. Edwards

Mrs. Janet Y. Harris

Leah F. Harris

Dorothy B. Heinmiller and Mikal Pippins

Mr. and Mrs. John H. Hughes

Brian E. Hudson and Jackson Pulmonary

Associates Team

Mississippi Health Partners, Inc.

Mississippi Valley Title Insurance Company

Mr. and Mrs. Eugene R. Naylor

Mr. and Mrs. C. Edgar Sentell

Mrs. Elizabeth F. Sligh

Tant'd Amis Luncheon Club Members

Mrs. Belinda D. Thomas

Mrs. Staci Tyler

Robert and Bobbie K. Ware

Mr. Marshall Zimmerman

Ms. Mary P. Zimmerman

Ms. Mozell Maxey

Mr. Jerry A. Estes

Ms. Ethel B. McCraw

Mr. William L. McCraw

Mrs. Gertie McNaughton

Ms. Billie McGee Ellison

Mr. Cooper Neil

Mr. Frank W. Gilchrist

Mrs. Anne Newman

Mr. Alfred F. Newman, Jr.

Mrs. Quinton B. Perry

Mr. Quinton B. Perry

Mrs. Mary N. Pinkerton

Ms. Alinda Bell

Mr. Tony Porter

Mrs. Aline A. Porter

Mr. Billy D. Porter

Mrs. Aline A. Porter

Mary Ruth and Paul J. Pryor

Mrs. Paula Pryor-Greer, Children

and Grandchildren

Mr. W. O. Ray

Mrs. Sally H. Hederman

Dalton Gene Rice

Martha and Brad Hooey

Ms. Joy Rieves

Drs. Becky and Chris Waterer

Ms. Arlevia Rogers

Mrs. Doris Christine Jackson

Mrs. Brenda Russell

Ms. Billie McGee Ellison

Dr. Carl Savell

Ms. Melissa L. Smith

Ms. Louise Sellers

Mr. and Mrs. James McRae and the

Monday Night Football Group

Mr. Leo R. Seymour

Mrs. Nancy Seymour Pate

Mrs. Darlene M. Smith

Mr. and Mrs. Newman E. Atkinson

Mr. and Mrs. Richard A. Brogdon and Family

Mr. Robert E. Frost

Mrs. Jennifer Heffner

Mr. Gary V. Martinelli

Ms. Darlene Nix

Mr. and Mrs. Thomas R. Slawson

Mr. and Mrs. Thomas Steelman and Family

Mrs. Doris B. Taylor

Mr. and Mrs. Rick J. Calhoon

Mr. Charlie Thompson

Ms. Billie McGee Ellison

Ms. Maurine C. Twiss

Dr. A. C. Tipton, Jr.

Willie and John Victor

Mr. and Mrs. Edward Lancaster

Mrs. Jane Patton Waterer

Drs. Becky and Chris Waterer

Mr. Anthony D. Williams

Mrs. Carol W. Williams

Dr. Otis B. Wooley, Jr.

Julie and Dudley Wooley

Your support means a great deal to us, and we have made every effort to list your name accurately. If your name is not listed as you wish, please call or email us. Thank you!

Carry the MISSION

In 2018, Carry the Mission celebrated **21 years of assisting employees in need and nonprofit organizations in our community**. Mississippi Baptist Medical Center's employees are very proud of this robust employee giving program with approximately 1000 team members contributing.

CTM has helped nearly 1500 employees and supported hundreds of nonprofits in our community since it began in 1997. In 2018, our co-workers **raised \$345,118**, with MBMC's match of 50 cents for every dollar employees contributed. This year, **CTM assisted 133 employees through Benevolence, Scholarship, and Christmas Assistance and supported 56 local nonprofit organizations.**

At Baptist, there is great enthusiasm for CTM and its mission of helping our co-workers and the community we serve.

Karen Abdeen*	Kathy Ann Ballard	Bruce Black, M.D.	Wilhelmina Natazha Bridges	Jimmie C. Cain
Sidney A. Ables	Darrell Banks	Danjunita Monay Blackmon	Jackie D. Brister*	Melanie Lisa Cain
Carolyn Turner Adair	Shareta P. Banks	Kathy M. Blackmon	Glenn P. Brogan	Nancy Marie Caldwell
Earnestine Adams	Angela Barber	Stephanie R. Blackmon	Jermaine Bronson	Shonda Calhoun
Margaret Adams	Robert V. Barham	Lana G. Blackwell	Angela L. Brooks	Amiee Elizabeth Campbell
Mary Lynn Adams	Pamela J. Barlow*	Christopher Blair*	Tyisha L. Brooks	Carolyn J. Campbell*
Andersen Nichole Adcock	Vivian M. Barnes	Deborah K. Blakeney	Chardonnea Brown	Deborah George Campbell
Janet Adkerson	Mary B. Barnett*	Tyra L. Bledsoe	Cleotha L. Brown	Jamalah M. Campbell
Sarah Jean Adkins	Ashley M. Barnette	Freddie R. Blocker	Laquinta D. Brown	Kimberly Campbell
Lindsay Adkinson	Niko Johnson Barnes	Tracy L. Boardman	Pamerlyn D. Brown	Mary Campbell
Carolyn S. Albright	Christy Hennington Barrett	Jessica Cannon Body	Patricia Brown*	Paul J. Campbell
Ezekiel Aldridge*	Frances L. Bass*	Eugeniya N. Boldyreva	Roy L. Brown	Lauren E. Cantrell
Patricia A. Aldridge	Michele Bates	Kentrice S. Bolton	Shirley T. Brown	Candice Lynn Cantrelle
Ashley Reed Alexander	Heather R. Batte	Taylor Alexis Bolton	Shwanda Taylor Brown	Tangela M. Carlton
Tabatha Alexander	Hollis Baugh	Lori Bone	William F. Brown	Shemika S. Carmichael
George D. Allard*	Timothy J. Baxley	Dungie L. Booker	Yolanda Brown	Bobbie Carpenter
Stacy L. Allen*	Zandra S. Baxter	Crisler Boone	Debbie Bryant*	Rhonda Carpenter
Carol Allen	Marvis C. Beard	Deliah D. Boone	Doris A. Bryant*	Hillary B. Carr
Chris Anderson	Bobbie Renee Beeland	Miranda A. Bounds	Gwendolyn Faye Bryant	Brandy L. Carraway
Heather R. Anderson	Amy L. Belk	Shellia A. Bournes	Lisa D. Bryant	Brenda Carter
Tiffany Hope Anderson	Heather F. Bell	Connie M. Bouslay	Tefaria L. Bryant	Jakeida J. Carter
Sholonda R. Andrews	Yolanda Y. Bell*	Lauren Kraft Boutwell	Deborah I. Bullock	Josephine R. Carter*
Rose M. Anthony	Maxwell Beluso	Bruce D. Boyd	Amelia K. Burch	Carmen K. Case
Marshelle Appell	Doris M. Bennett	Sarah E. Boyd	Linda Burchfield	William B. Castle, M.D.
Lakisha Armon	Melissa R. Bennett	Betty A. Bracey	Allen Burden	Brenda M. Castleberry*
Sarah Arnett	Tanya R. Bennett	Dianne Braddock*	Mary Burkes	Keith O. Catchings
Roshonda Arrington	Benita Benson	Brenetta Braddy	Kelly Elizabeth Burns	Wanda Catchings
Tracey M. Arterberry	Dena S. Benson	Jessica S. Braddy	Jennifer Burns	Arthur K. Causey*
Mary Elizabeth Mann	Shelia Bentley-Snow	Dianne Michelle Bradford	Angelique Burnside	Glenda K. Cauthen*
Austin	Amy Teresa Bernard	Micheal Keayon Bradley	Latoria Raenitha Burrell	Tavia L. Cavett
Gary Austin	Jennifer S. Berry	Ashley Michelle Branch	Precious K. Burse	Morgan Elise Chalk
George P. Ayers*	Kurtlon Scot Berry	Mary Elizabeth Brannan*	Sara Jean Burt	Dwight D. Chambers
Deborah Backstrom	Matthew P. Berry	Joan Branson*	Gary P. Bush	Matthew P. Chambers
Tracy Ann Bacon	Melanie Berry	Alisa L. Brashear	Nancy D. Butcher*	Peggy Chamblee
Rosie M. Baggett	Tanika L. Bess	Tina P. Braswell	Kandace F. Butler	Jennifer Ann Chambless
Gwendolyn M. Bailey	Chaddrick P. Bibb*	Jennifer Knowles Breland	Kim Butler	Sharon D. Chancellor
Charlyne Bailey	James R. Biggers	Roslynn L. Brent	Teresa A. Butler	Angela Chandler, M.D.
Deatrice Baker	Gloria G. Bilbrew	Amy Brewer	Becky Buxton	Cara N. Chandler
Gregory D. Baldwin	Pamela D. Bingham	Bryan K. Brewer*	Richard B. Bynum	Robert A. Channell
Laura S. Baldwin	Thessalonia M. Bingham	Milissia Denise Brewer	Felicia Denise Byrd	Fredrika J. Christian
Tonya M. Ball	Tina Bjornerud	Jessica K. Bricker	Jamie Byrd	Jacob Evans Clack
John H. Ballard	Brittany Nicole Black	Jan L. Bridewell		Laci M. Clack

*20 consecutive years of giving

Thank you FOR CARRYING THE MISSION

- Jasmine Clanton
Allison McGowen Clark
Ashley P. Clark
Philandric D. Clowers*
Katherine A. Cobb
Maxine Cobbins
Karen Marie Cole
Deborah Coleman
Robert A. Coleman
Ronald Coleman*
Shirley A. Coleman
Wallace C. Coleman
Yalonda S. Collier
Evelia C. Collins*
Heather Collins
Reginia Y. Collins
Savannah Zachry Collins
Tiffany Collins
Hugh W. Comans
Charlene Combest*
Amelia Conner
Carmen Marie Cook
Belinda Cooley
Rosa D. Cooper
Sherry L. Cooper
Linda K. Corley
Samantha Lyn Corley
Charles E. Cossett
Cathy J. Cotton
Gwendolyn Cotton
Steven R. Cox
Crystal Craft
Kathleen C. Crittenden
Vickie S. Crowell
Frankie M. Crowley*
Semekia T. Cubit
Angela Letrece Daniels
Kathy W. Daniels
Tiffany Denise Darden
Cecelia Darling
Amanda S. Davis
Annette Davis
Christina D. Davis
Danielle Renee Davis
Denisa B. Davis
Freda L. Davis
LeKishi T. Davis
Rebecca D. Davis*
Trudy C. Dawkins
Brenda M. Dean
Kimberly Harlan Dear
Keli Lynn Deen
Linsie L. Delorme
Nancy Demus
Stefanie Dendy
- Alison S. Dennis
Bonita E. Dennis
Amy S. Dent
Barbara Dickerson
Samuel David Dickinson
Shauna L. Diehl
Terri S. Diddy
Donna B. Digiovanni
Carman R. Dixon
Helen J. Dixon
Mae E. Dixon
Vanessa A. Dixon
Linda L. Dobbins*
Monica Doby
Lindy S. Donald
Brittany Monique Donelson
Kelli A. Dorsey
Earlean Dortch
Deborah F. Doss
Elizabeth Dotson
Kristyn Drew
Jerlunda Dudley
Donald R. Duerson
James M. Duff*
Becky Duggan
Stephanie D. Dukes*
Adrienne M. Dunbar
Erica L. Dupree
Eliza Lindsey Durr
Kayla Sade Durr
Wendy L. Durrell
Karen J. Eckerson
Hampton L. Edwards*
Pamela Edwards
Paula O. Edwards
Vicki Vance Edwards
Adelia A. Eiland
Robert R. Eiland
Teresa G. Ellerbusch*
Laura Ellingburg
Mollie Ellington
Kayla Ellis
Kristi Ellis
Patricia Jane Ellis
Porscha Ellis
Sherry Shernell Ellis
Rita Embry*
Anna G. Emory
Jacqueline E. Ephraim
Pamela B. Epps
Scott M. Epps
Sharron R. Epting
Cynthia Erickson
Sandra B. Estes*
Connie S. Evans*
- Kashina M. Evans
Phillip A. Evans
Jennifer Evans
Jill Ellen Evans-Barnes
Abigail Marie Everett
Gene Everitt
Stephanie Faulkner*
Alisha Federick
Ashley Fedrick
Kim D. Felder*
Corinne Felton*
Jessica Felton
Heath G. Ferguson
Laurie A. Ferrell
Barbara J. Fields
Helena L. Fields
Shawanda Fields
Sondra R. Finkbeiner
Julie T. Flint
Jodi B. Flowers
Donna G. Floyd
Carl Stephen Foley
David K. Foley*
Angie Ford
Antress Denise Ford
Bobbi J. Ford*
Lee A. Foreman
Takeyla L. Forrest
Amber Ariel Foster
Jessie Foster
Janice M. Fowler
Karin M. Fox
Joyce Lowe Franco
Donna Little Frank
Paul C. Frank
Robert S. French
David L. Friday
Kathryn M. Fridmanski
Wren C. Fulton
Nettie B. Fuqua
Patrick Gaddis
Martha Nickson Gaines
Takangela D. Galloway
Casey A. Gange
Mary A. Gannon
Jo L. Gardner
Terry R. Gardner
Jeffrey Alan Garrett
Bethany Lasseter Garrison
Paul S. Gatewood
William Gatlin
Charles K. Gauthier*
Roxanne M. Gay
Callie J. Geno
Tenika T. George
- Vickie B. Gerrard*
Kimberly M. Giachelli
David M. Gibbs
Angela Q. Gibson
Edna Gibson
Lashonda Gibson
Bianca Chanel Gills
Morgan Michelle Ginn
Marilyn S. Glenn
Cynthia L. Godfrey
Debbie A. Goldberg
Jody C. Gong
Cassandra A. Goodin
Curtis L. Goodin
Sandra Goolsby
Shelia D. Gordon
Mary A. Gordy
Toxie H. Gore*
Katherine Graham
- Linda S. Graham
Katina R. Grantham
Tricia Jane Grantham-Price
Ophelia Nicole Grant-Johnson
Alice Ruth Gray
Charles D. Gray
Cherry A. Gray
Jimmy B. Gray
Kennedy R. Gray
Kimberley Kamil Gray
Michelle M. Gray
Latoya Grear
Lawrence Green
Marilyn E. Green
Sicily K. Green
Talia Dashun Green
Vickie Green
Jacqueline Greene



TONY JAMES

Wellness Director

“My reason for giving to Carry the Mission is based on Philippians 2:4 which is basically helping others with humility and selflessness. That’s just what we do at Baptist!”

Thank you FOR CARRYING THE MISSION

Erica L. Greenwood
 Emma L. Greer
 Bernard V. Grewe
 Kimberly Griffin
 Michael D. Griffith
 Tammy Grimes*
 Amy Bond Grissett
 Sharon Williams Gross
 Jiaqi Katie Guan
 Briana Latice Guillory
 Johnny W. Gunn
 Tiffany Lanee Gunn
 Dawn P. Gurley
 Bernice E. Guydon
 April R. Guynes
 Angela B. Hahn
 Halee M. Hales
 Crystal Patrick Haley
 Vickie L. Haley

Elissa Rodgers Hall
 John M. Hall
 Latasha Shundrahl
 Hall Lucy L. Hall
 Tara Hall
 Thelma R. Hall
 Joe A. Hall Grant
 Robin M. Hamilton*
 Tanya Hamilton
 Vinessa Lee
 Hamilton-Mays
 David G. Hamm*
 Jennifer M. Hamm
 Dana N. Hammitt
 Albert S. Hammons*
 Lisa H. Hankins
 Kay C. Hanley
 Tammy W. Hannah*
 Helen Cowen Harden

Marisa Laine Hardin
 Renee R. Hardwick
 Julie C. Hardy
 Mary A. Harper
 Virginia C. Harrell
 Ariel C. Harrington
 Courtney A. Harrington
 Christina Johnson Harris
 Dorothy J. Harris
 Kayla Bailey Harris
 Leah F. Harris
 Lynda Harris
 William K. Harris, M.D.
 Adriane Wright Harvey
 Joshua T. Harvey
 Ronnie C. Harvey
 Tammy Gayle Harvey
 Linda Hatten
 Monica H. Hawthorne
 Caitlin Foreman Hayden
 Meredith Duncan Hayles
 Kathy W. Haynes
 Robie D. Hays
 Lynda Hazen
 Massie H. Headley, M.D.
 Kenya H. Heath
 Alicia Williams Hemphill
 Judy C. Henderson*
 Summer Ashley Brooke
 Henderson
 Brian M. Hendley
 Bertrina L. Vance Henry
 Ira Vontrell Henry
 Sharon Henry
 Dale L. Herrington
 Patricia J. Herrington*
 Amy R. Higginbotham
 Sara Michelle Highfill
 Bethany B. Hill
 Jamie L. Hill*
 Lori H. Hill
 Melissa C. Hill
 Shirlene Hill
 Edwin L. Hilton
 Charlotte P. Hines*
 Jennifer Hines
 Heather R. Hobby
 Brenda W. Hobson
 Lisa B. Hodges*
 Timothy A. Hodges
 Angela L. Hoffberg
 Charlotte W. Hogan
 Casey I. Holder
 Deborah K. Hollingsworth
 Deloria Hollins

Jacqueline C. Hollins
 Marcia J. Holloway
 Morgan Holloway
 Sandra Mechelle
 Holloway-Jackson
 Betty Hollowell
 Dynasti Cierra
 Mechelle Holmes
 Lisa C. Honeycutt
 Martha Howell Hooey
 Dominic R. Hooker
 Shirley Horn
 Kimberly Marie Horne
 Lula M. Horton
 Wanda F. Horton
 Linda K. Houston
 Brenda A. Howie*
 Leanne B. Huckaby
 Dianne Hudson
 Gwendolyn Hudson
 Lakysa Monique Hudson
 Meshell Denise Hudson
 Sharon C. Hudson
 Minnie P. Huff
 Martha C. Huffman
 Phillip W. Hughes
 Catherine Hughes
 Amanda Hope Huit
 Anna L. Hull*
 Alvin P. Hulsey
 Jennifer Lewis Humphries
 Pennye Humphries
 Dianne Jones Hunt
 Denice D. Hux
 Mary Margaret Ivey
 Rebecca A. Ivy
 Daisy Jackson
 Gloria J. Jackson
 Jeremiah L. Jackson
 Kacie Jackson
 Kelsey Jackson
 Kimberly D. Jackson
 Leona Regina Jackson
 Nafeesha Malik Jackson
 Ophelia Jackson*
 Priscilla Jacobs
 Rhoshounda T. Jacobs
 Alma James
 Tony L. James
 Glynette M. Jeffery
 Carlee F. Jenkins
 Meghan V. Jerkins
 Kathy M. Jett
 Kaccy Nichol
 Jimmerson-Allen

Christine R. Johnson
 Dean Russell Johnson
 Henratta Johnson
 Kayla A. Johnson
 Linda E. Johnson
 Nicole Leigh Johnson
 Shameka Johnson
 Summer Arlene Johnson
 Vera A. Johnson*
 Barbara D. Johnston
 Kelly M. Johnston
 Laurie Johnston
 Lewis D. Johnston, M.D.
 Michael Johnston
 Karion Marie Jolly
 Angela H. Jones
 Anya Jones
 Deanna L. Jones*
 Hanna L. Jones
 Keith Walton Jones
 Lashi U. Jones
 Laura L. Jones*
 Linda G. Jones
 Lisa Jones
 Michelle S. Jones
 Wesley A. Jordan*
 Joann Joyner*
 Aneda A. Julkenbeck
 Anees H. Kanorwala
 Samuel Gillespie Kealhofer
 Shannon L. Kellenberger
 Eleese A. Kelly
 Jacqueline S. Kelly*
 Kenyatta R. Kelly
 Scott Kelly, M.D.
 Shannon Renee Kelly
 Sharon Kelly
 Emily Kemp
 Jennifer Renee Kendrick
 Katherine Ciara Kennedy
 Annie L. Kern
 Sherry L. Kernop
 Janice L. Kersh
 Ratrina Keys
 Joe O. Kilpatrick*
 Angela Kimble
 Sherri Sims Kimbrow
 Bonnie King
 Elaine King
 Georgia King
 John King
 Juanita G. King
 Wanda W. King
 Kyla C. Kinnard
 Barbara Kirby



ALISA BRASHEAR

Social Worker

“Carry the Mission speaks to the heart of who we are at Baptist. It provides a way to help people in need whether it’s our friends we work with or the community members we serve.”

Thank you FOR CARRYING THE MISSION

Leslie A. Kirk
 Afton Clarice Kitchen
 Amanda Kittrell
 Jennifer A. Knight
 Kitty S. Knight
 Leanne F. Knight
 Patricia L. Knighten*
 Roshinda O. Knott
 Jimia Kohn
 Carlynette M. Lacey
 Larry Lacey*
 Nelda S. Lackey*
 Brittany Lain Ladd
 Pamela Ladd
 Lorrie Kathryn Laird
 Nancy M. Lamparty*
 Leslie K. Lancaster
 Melissa Wray Landaverde
 Cindy F. Landers
 Toni C. Lane
 Kathy L. Lark
 Ronda R. Larrys
 Lacy Carpenter Latham
 Dale L. Lawrence*
 Marcia Susan Shanks
 Lawrence
 Anna M. Leach
 Joseph Ledbetter
 Brenda M. Ledoux*
 Larry D. Lee
 Michael F. Lee*
 Nytease Danielle Lee
 Robbin J. Lee*
 Lashunda Leflore
 Myra G. Leigh
 Amy L. Lemmons
 Shanna Lemon
 Wanda C. Lett*
 Stephanie Levy
 Betty R. Lewis*
 Joanna H. Lewis
 Linda F. Lewis
 Ricky L. Lewis*
 Steffany Gale Lewis
 Susan Lewis
 Calvin E. Lighter
 Kristen S. Liles
 Kenneth G. Limbaugh
 Notrie A. Lindsey
 Elizabeth C. Lishman
 Kimberly C. Little
 Leontyne Littleton
 Gina M. Lobo
 Kimberly Lynn Loe
 Teresa M. Lofton
 Edna M. Logan*
 Dianne Deramus Lolley
 Chander G. Lott
 Delois T. Lott
 Munisha G. Lott
 Earlene L. Louis
 Emily D. Lowe
 Erin Lowe
 Judith A. Lowe
 Jennifer Lubiani
 Faye G. Lucius*
 Brownie Lockett
 Gloria B. Lockett*
 Shawn D. Lockett
 Martha R. Lynch
 Brenda T. Lyons
 Valerie J. Mack
 Michelle D. Macoy
 Alisa R. Magee
 Debra Magee
 Monty L. Magee*
 Tina L. Magers
 Karla N. Magness
 Leigh A. Mallard
 Diakeema Pearl Mallett
 Terra Denae Mallette
 Shellie M. Mangum
 Stephanie R. Manning
 Natalie Manogin*
 Eric S. Manuel
 Joy Marble
 Rachel C. Martella*
 Diane O. Martin
 Erin M. Martin
 Lee V. Martin
 Monica Lenore Martin
 Derrick Mason*
 Dianne Mason
 Fortenise A. Mason
 Gloria Mason
 Sarah J. Mason
 Sara Massey
 Pamela P. Matheny
 Donna C. Mathews
 Baron D. Matthews
 Calvin Matthews*
 Gwendolyn D. Mayes
 Martha R. Mayes
 Johnny L. Maynor
 Jemel L. Mayweather
 Christina C. McAlpin
 Lisa Renea McAlpin
 Bethany A. McBeth
 Jeanetta McBeth
 Kenneth McBeth
 Megan Marie McBride
 Ashley Baker McCain
 Memrie Allison McCaleb
 Michelle McCann
 Kaiwaunn J. McCarty
 Terri C. McCarver
 Ashley Ramage McClain
 Mary E. McClendon*
 LeTiae McCoy
 Nathan J. McCracken
 Joanna Lauren McDaniel
 Matthew E. McDonald
 Molly F. McDonough
 Kimberly Ann McElroy
 Linda R. McEntee*
 Anthony C. McFarland
 Barbara McGee
 Jessica L. McGee
 Amanda L. McGruder
 Mary A. McInnis*
 Horace H. McIntosh
 Peggy G. McIntosh
 Bonnie G. McKee*
 Jennifer Lynn McLain
 Susan McLaughlin
 Monique M. McLaurin
 Paulette L. McLaurin
 Braxine McLemore
 Kathy Mason McLemore
 Rebecca A. McMorris
 Alicia K. McWilliams
 Ashley N. McWilliams
 Mary Agnes H. Middleton*
 Roselynn B. Middleton
 Crystal Miles
 Brenda Martin Miller
 Ladettria Devon Miller
 Lena J. Miller*
 Mattie M. Miller
 Frederick A. Mills
 Rosemary Milner
 Albert L. Milton
 Blair Mackenzie Minyard
 Jerry D. Mobley
 Joseph B. Montgomery, M.D.
 Paul M. Montgomery*
 Cooper B. Moore
 Stephanie M. Moore
 Tammy R. Moore
 Rutha Moorehead
 Felicia Marie Morris
 Shineka Y. Morris
 Robin B. Morrison*
 Derose L. Mosley
 Kimberly Moss
 Dennis Moulder
 Sharon L. Mounger
 Amanda Brooke Mullins
 Ernestine Murphy
 Linda T. Myers
 Christopher L. Nail
 Calendria I. Nash
 Ida Nash
 Debra A. Neal
 Robert E. Neal*
 Jennifer Neathery
 Daqunita Nachele Nelson
 Marvin Jerrell Nelson
 Stefanie S. Nelson
 Walterine T. Nelson
 Jennie Lee Newcomb
 Lanese B. Newell
 Lorenzo Newell
 Cyndreika Kiaria Newton
 Freedom M. Newton
 Amanda T. Nichols
 Melissa A. Nichols
 Tiffany S. Nichols
 Waltrica Nichols
 Douglas V. Noel
 Allyson Norman
 Heather A. Norrell
 Ladonna K. Northington
 Sheila H. Norwood
 Jennifer K. Nunley
 Bernadette B. Nwagwu
 Nancy E. Oberhausen
 Michael Odie
 Techaka N. Oliphant
 Virginia M. Orey
 Joshua Osborn
 Sara Elizabeth Ostrander
 Mary J. Overstreet*
 Jordan L. Owen
 Sarah E. Owen
 David B. Owens*
 Queen E. Owens
 Rebecca Chick Pace, M.D.
 Keisha Lashae Pack
 Gwendolyn Y. Palmer
 Sara J. Palmer*
 Elmer M. Palmer, Jr.
 Meghan M. Palmore
 Joanne E. Papa*
 Christina P. Parker
 Lauri R. Parker
 Tammy C. Parker
 Susan Parkerson
 Misty M. Passons
 Barbara F. Pate
 Reese B. Pate
 Numrata Patel
 Kandi Patrick
 Attica J. Patterson
 Susan B. Patterson*
 Steven M. Paulson
 Erica L. Payne*
 Rebekah K. Peacock
 Meghan L. Peebles
 Misti R. Perez
 Angelynn N. Perez
 Christy Belinda Perilloux
 Michael P. Perilloux
 Ronald D. Permenter
 Arlene B. Pettus*
 Hannah Sexton Pharr
 Dianna S. Phillips
 Rosalyn N. Phillips
 Diana Pickel
 Claudia P. Pierags
 Pamela Triplett Pilgrim
 Sandra Pinkard
 Jason J. Pitre
 Kitty M. Pitts
 Mary E. Plunkett
 Carol H. Polk
 Deniece E. Ponder
 Karen Laird Ponder
 Sandra S. Poole
 Kenny L. Pope
 Mieacha Briana Porter
 Angela D. Potter
 Michael Presley
 Mildred K. Prewitt*
 Arquilla Price
 Donna W. Price*
 Tonia W. Price
 Cynthia L. Primer
 Julie F. Prisock
 Julie P. Puckett
 Rose Elizabeth Pugh
 Ashley Pullen, M.D.
 Ginger H. Pullen
 Carolyn Kent Purvis
 Cassandra F. Purvis
 Marcus D. Purvis
 Nisheka T. Purvis
 Teresa A. Purvis
 Carolyn M. Quarles*
 Randy A. Quattlebaum
 Dawn Quayle
 Kristy G. Quenneville
 Bertha Quinn
 Bettye Quinn*
 Jackie D. Quinn*

Thank you FOR CARRYING THE MISSION

Ashley E. Rachel
Melissa Jude Ramirez
James E. Ramsey
Vernon Randles*
Donna Kay Randolph*
Dorothy N. Randolph
Jay D. Rao
Santana M. Ratliff
Yolanda B. Ratliff
Patsy Hathorn Raworth
Linda J. Readus
Stacie H. Rector
Donnya M. Reed
Lasonja S. Reed
Monica A. Reed
Steven B. Reed
Mary K. Reedy
Jason Reeves
Lou A. Reid*

Mollie S. Reynolds
Justin S. Rhodes
Scott W. Rhodes
Heidi H. Rhodus
Tina K. Rice
Adam G. Richardson
Carol C. Richardson
Christell Richardson
Felicia Richardson
Robert L. Richardson
Shandon Paige Richardson
Annie B. Ricks
Timothy E. Rieckman
Candice R. Riley
Jamie J. Riley
Jennifer Paige
Riley-Mahaffey
Amanda Roberson
Tabatha Roberson

Esther A. Roberts
Christopher D. Robinson
Krista A. Robinson
Linda F. Robinson
Race Stephen Robinson
Shirley D. Robinson
Tarsha L. Robinson
Cody L. Rood
Marilyn C. Roper
Robin R. Rosenbaum
Abbey Muncher Ross
Flora M. Ross*
David Blake Rounsavall
Lindsey Corbin Rowland
Megan Alderman Ruitter
Jimmy R. Rushing*
Willie R. Rushing
Adrienne S. Russell
Darrell W. Russell*
Deloris Russell
Michelle Russell
John Ryle
Crystal Barrow Sago
Danny R. Salers*
Conedra Ragime Samuel
Arlena Kaye Sanders
Belinda Sanders
Bettie J. Sanders
Gloria M. Sanders
Mary A. Sangster
Robert M. Saunders
Stephanie C. Saunders
Etta Saxton
Kelly A. Scarberry
Allison Schuler
Cynthia H. Scott*
Tara L. Sebren
Alexandra Danielle Selby
Elizabeth A. Self
Amanda Bowen Sellers
Susan Shertain Shaffer
Mary Etta Shaidnagle
William Edward Shearer
Whitney Brooke Shedd
Haley A. Shelby
Erica Michelle Shepard
Sellie Billy Shines
Lydia L. Shoemake
Johnny R. Simmons
Kanisha Simmons
Tiffany Simmons
Carolyn R. Simpson
Dorothy S. Simpson*
Shelby Elizabeth Simpson
Diane M. Sims

Heather A. Sims
James R. Sims
Donna J. Sinclair
Virginia R. Sirven
Heather G. Skinner
Chrystal Miesha Slaughter
Carlissa Smith
Christi L. Smith
Cindy F. Smith
Claretha Smith
Debra A. Smith
Debra Lynn Smith
Elizabeth Jean Smith
Gloria D. Smith
Gwendolyn Horne Smith
Janice H. Smith
Jeff D. Smith
Jennifer Cockrell Smith
Jerry M. Smith*
Keith E. Smith*
Leslie Smith
Linda Smith
Melanie P. Smith
Michaela Danielle Smith
Ora J. Smith
Sherry L. Smith
Solon B. Smith
Stephanie N. Smith
Heath H. Smylie
Pamela S. Snell
Jose A. Sosa
Annie Southern
Esther R. Spain
Janice Y. Spann
Muffy Spears
Tabitha Spears
Carmen Rebecca Speece
Barbara A. Speights*
Angela L. Spell
Cherreana Spencer
Cynthia K. Spiers
Joseph W. Spruill
Madison Blaire Stackhouse
Shanna Renee Staines
Steven M. Stanic
Cori D. Stanton
Shentolya E. Steed
Janet K. Steen*
Jordan Warren Steen
Latonya Faye Stephenson
Alicia N. Stepp
Jasmine S. Sterling
Beth F. Stevens*
Jennie A. Stevens
Michael K. Stevens*

Sherry E. Stevens*
April S. Stevenson
Albert J. Stewart*
Anissa M. Stewart
Ashley Stewart
Craig Stewart
Ophelia T. Stewart
Sandra J. Stewart
Michael W. Stiglets*
Liza Noel Hudspeth
Stockman
Bobby J. Stokes*
William L. Stoltzfus
Leslie A. Stoufer
Mary V. Stover*
Alexis Grabow Strahan
Victoria M. Straughter
Karlene C. Strayer*
Joshua W. Street
Cletus W. Stringer*
Lana W. Strobel*
Charline K. Strong
John N. Strother
Tony W. Strowd
Wanda I. Strowd
Kaye M. Stuart
Sharon Stubbs
Sonja D. Stuckey
Carrington Clement
Sullivan
Leah C. Sullivan
James R. Sumrall*
Deloris R. Surrrell
Tiffany A. Sutton
Ursular J. Sutton
Helen R. Swan
Stephanie Shee Swilley
Arthur D. Swyers
Barbara G. Tadlock
Linda Talley*
Augaesha Joante Taylor
Bianca Latrice Taylor
Connie J. Taylor
Jasandra A. Taylor
Katie Taylor
Lashanda E. Taylor
Rhonda W. Taylor
Susan J. Taylor
Susan Marie Taylor
Joann Sienkiewicz Teetson
Belinda D. Thomas
Brenda J. Thomas*
Charles Thomas
Ester L. Thomas
Kimberly D. Thomas



EVELIA COLLINS

Senior Physical Therapist

“I give because I’m blessed and I feel it’s my mission to bless others. CTM’s strong dedication to employee benevolence and the community makes me feel good about my support.”

Thank you FOR CARRYING THE MISSION

Tammy Denice Thomley
 Barbara A. Thompson
 Clementine Thompson
 Gloria R. Thompson*
 Heather W. Thompson
 Jannie M. Thompson*
 Lisa Thompson
 Tiara S. Thompson
 William F. Thompson
 Melissa J. Thornton
 Twasa Y. Thornton
 Deborah Thrash
 Shelby Shields Thrash
 Catina Nickole Tidwell
 Dwayne A. Tidwell
 Rita M. Tierney
 Joseph C. Tillman*
 Valeria B. Tillman
 Wendy Tolson
 Keianna Renae Torrey
 Melissa A. Touchstone*
 Sonji E. Touchstone
 Theresa L. Towers
 Adrian Paige Trammell
 Clarice N. Travis
 Mary K. Traweek
 Leighea M. Triplett
 Debra Trussell
 Jennifer Reed Tuccio
 Dora J. Tucker
 Madison V. Tullos
 Grace Tupper
 William S. Turcotte*
 Diane Marie Turner
 Richard E. Turner
 Robert Turner*
 Rhonda Tyler
 Tuesday M. Tyler
 Christina M. Tyrone
 Dorothy F. Underwood
 Melanie Edwards
 Underwood*
 Demetrius Unger
 Stephanie Lynn Upton
 Mary Grace Valentine
 Samuel J. Valentine
 Cynthia Hastings Vance
 Kayla Vance
 Misty Lynn Vance
 Natalie U. Vandevender
 Jennifer M. Varner
 Joy S. Vaughn
 Glory J. Vaxter*
 Clara M. Versell
 Charleigh A. Vickers

Shelia Vincent
 Rebecca Ellen Waggoner
 Brandi B. Wagner
 Adriane A. Walker
 Amanda Rose Walker
 Emily Lynn Walker
 Kellye Renae Walker
 Kysha W. Walker
 LaShundra Monick Walker
 Mary Kathleen Walker
 Virginia J. Wallace
 Troy O. Walters
 Linda A. Waltman
 Velma J. Walton-
 Shakespeare
 Amanda Paige Ward
 Perry D. Ward
 Bobbie K. Ware*
 Brandi Vance Ware
 Robert Ware*
 Sybil D. Ware
 Gloria A. Warner*
 Jeanette Warren*
 Matthew Kyle Warren
 Deloris Washington
 Pamela Gail Washington
 Stephanie Washington
 Monturia C. Watkins
 Brianna Dawn Watrous
 Tracie E. Watson*
 Barbara A. Weathersby
 Carrie S. Weathersby*
 Glenette Weathersby
 Ruby T. Weathersby
 Barbara O. Weaver
 Constance N. Webb
 Alison S. Weir
 Courtney Gray Welch
 Sondra Shantel
 Welch-Orey
 Gabrielle Wells
 Jerry L. Wells
 Lou A. Wells
 Tina S. Wells
 Arlillian M. West
 Audrie N. West
 Byron G. West*
 Christina Shauneice West
 Tiffany S. West
 Mary H. Westbrook*
 Kathryn Westmoreland
 Jessica Wheaton
 Charlene G. Whitaker
 Patrick S. Whitaker
 Teanna Whitcomb

Corey T. White
 Jane E. White
 Jennifer Dawn White
 Kendra Foster White
 Lyndsey Madison White
 Alan D. Whitfield
 Destinee Hope Whittington
 Shanna M. Whitwell
 Carolyn B. Whyte
 Debbie Wilcher
 James Andrew Wiley
 Scott D. Wilkinson*
 Betty J. Wilks*
 Larry Wilks
 Angelica Denise Williams
 Aniesha C. Williams
 Brenda Giles Williams
 Cajan A. Williams*
 Carolyn Y. Williams
 David Williams
 James A. Williams
 Jan S. Williams
 Katina M. Williams
 Natasha P. Williams
 Phyllis D. Williams
 Phyllis M. Williams
 Robert J. Williams
 Sanana Q. Williams
 Shanequa Lashunda
 Williams
 Tabitha Williams
 Tangelia F. Williams
 Tanya M. Williams
 Tina Michelle Williams
 Barbara J. Williamson
 Lisa L. Williamson
 Terri L. Williamson
 Cheryl D. Willis*
 Victoria V. Willson*
 Sherry Renee Wilmoth
 Abby W. Wilson
 Ethel D. Wilson
 Faith Renee Wilson
 Linda S. Wilson
 Pamela M. Wilson
 Shaunte Marie Wilson
 Jonathan Windham
 Nicole R. Winham
 Andrea W. Winnett
 Joe K. Winstead
 Sherry Winstead
 Lora Winston
 Deborah Wise
 Edna M. Wolcott
 Eyonna Wolfe

Jessica P. Wonsley
 Amber D. Wood
 William Calmes Wood
 Charles C. Woodall
 Matthew H. Woodruff
 Linda Woods
 Ariel Deanna Wright
 Sherlenda Wright
 Justin Matthew Wyatt
 Ethan Yandow
 Randy A. Yates*
 Douglas L. Yeager, M.D.
 Cynthia C. Yelverton
 Beverly Ann Young*
 David M. Young
 Grenisha L. Young
 Kimberly F. Young
 Latosha Young
 Katina L. Younger

Muna Farasha Zeini
 Michael Zhang
 William Zorn
 Kathryn A. Zubatuk



WILLIAM ZORN

Senior Analyst

"I give to Carry the Mission because it is a way for me provide assistance to my coworkers who need it most. Also, it's a great way to give back to the community!"

BOARD OF REGENTS



Chris Anderson



William C. Ashford, M.D.



Dolph Baker



Alon Bee, Jr.



*Rick J. Calhoon
Chairman*



Lee Carson



Chris Coleman



Jason Greener



Melissa Hederman



Doug Hederman



Arthur F. "Skip" Jernigan



Bill Lampton



Margaret McLarty



Kurt W. Metzner



Mary Shapley



*J.H. "Tommy" Thames, Jr.
Vice Chairman*



Tom Underwood



Bobbie K. Ware



H. Chris Waterer, M.D.



W. Andy Wimberly



Dudley Wooley

FOUNDATION STAFF

Crisler M. Boone
Executive Director

Laura L. Jones
Director of Annual Giving

Ina Taylor
Data Coordinator

Martha H. Hooley
Events and Development Specialist

Michelle Scarbrough
Office Manager

LEGACY SOCIETY

The Legacy Society honors, and is open to, anyone who includes Mississippi Baptist Medical Center as a beneficiary in a will, trust, gift annuity, life insurance policy, or other such planned giving vehicles.

Anonymous*	Mr. Zach T. Hederman, Sr.*	Mr. Bob W. Pittman
Anonymous*	The Estate of Evelyn D. Hite*	Dr. John M. Purvis
Dr. Robert L. Abney III	Mrs. Mary H. Holyfield*	Regions National Bank
Mr. Woodrow W. Bailey*	Memorial Scholarship Trust Fund	Mr. Ralph E. Rives*
The Estate of Michael E. Barnes	Horne, LLP	Mr. Danny R. Rutland
The Estate of Lillian Simpson Bottrell*	Mr. E. William Hughes, Jr.*	Martha Frances Sheffield*
Mr. Mark Shelton Bounds	Mr. Alvis T. Hunt*	Charitable and Religious Trust
The Estate of Rev. Amos B.*	Mr. Ted D. Jackson	William Michael Shingleton*
and Mrs. Atlanta R.* Brown	Mr. Donald L. Kilgore	Memorial Endowment
The Estate of Mr. Jack* and	Dr. Thomas L. Kilgore, Jr.	Mr. Robert W. Shipp* &
Mrs. Charlotte* Brown	Mrs. Betty Stansbury Lacy*	The Mary Shipp* Trust Fund
Mr. Aaron H. Burris*	The Collin T. Lane* and Ola A.	The Carol Smith* Memorial Endowment
Drs. Gailya* and Jay Chance	Lane* Charitable Foundation	The Estates of Mr. and Mrs. J.
The Estate of Mr. James and	The Estate of Donal Bethea Marcus*	Franklin Smith
Nell* Chisholm	McCarty-Holman Jitney-Jungle	Mr. Jon David Smith
Julian* and Mildred Clark*	Stores of America, Inc.	Mr. Kendall R. Smith
Mr. and Mrs. R. L. Covington*	Rev. John* and Mrs. Judine T. McDonald	The Estate of Mrs. Kate Holder Spalding*
The Estate of Mrs. Nan Hemby Cox*	Mr. William D. McKinnon	& Dr. Edward M. Holder*
Mr. Gary B. Cress	Kurt and Dianne Metzner	and The A.B. Holder Trust
Mr. Richard M. Dean	Mr. Richard L. Miller*	The Davenport-Spiva
Deposit Guaranty National Bank	The Estate of Mrs. Valda Miller	Charitable Educational Trust*
Mrs. Sandra S. Finley	Mississippi Valley Gas Company	Dr. James W. Street*
The Estate of Lisa G. Forbes*	Mr. Paul G. Moak, Sr.*	David & Pamala Streilein
Fox-Everett, Inc.	Mrs. Mary Nell* and Mr. Osler A. Moore	Mr. M. Kent Strum
Dr. Guy T. Gillespie, Jr.*	Mrs. Billie S. Moore and Mr. Osler A. Moore	Dr. John A. and Mrs. Donna C. Temple
Mr. Joseph N. Goodell	The Estate of Mr. Frank Larry Murray*	Mr. and Mrs. J. H. "Tommy" Thames, Jr.
Dr. Ron and Mrs. Sheila Gray	The Estates of James B.* and	The R.V. Powers* and Robert E.
The R.H. Green* Foundation	Martha Lucille McGee Parker*	Lake* Foundations
Mrs. Lois S. Griffin*	Mrs. Jo H. and Mr. William T. Patterson	The William H. Ellsworth* Foundation
Dr. Elmer J. Harris*	Mrs. Fannie Elizabeth Payne*	Trustmark National Bank
Mrs. Janet Y. Harris	The Estate of Mrs. Charlotte Peets*	Mr. Howard E. Walker*
Mr. Charles L. Harrison	Mr. and Mrs. Fred W. Perian	The Estate of Dr. James Percy Wall*
Mrs. Coral B. Harwell*	The Estate of Miss Jean	Michael C. Wilkinson* and
Mr. H. Henry Hederman, Sr.*	Ragland Pettigrew*	Berneda R. Wilkinson
Mr. Hap Hederman*	The Estate of Max L. Pharr, M.D.*	Mrs. Betty Ann Williamson
		Mr. Julian B. Williamson

*Deceased

ESTATE & GIFT PLANNING ADVISORY BOARD

C. Tyler Ball	C. David Cleland,	James K. Dossett, Jr.	Tara C. May	Joe W. Parker
Donna W. Bruce, <i>Chair</i>	<i>Vice Chair</i>	Ted B. Edwards	Ronald C. Morton	Rita B. Parker
Steve M. Butler	Woody D. Coleman	Ted D. Jackson	Wendy R. Mullins	Ralph A. Yelverton
Karl E. Byrd	Jessica Cooley	J. Randall Mascagni	Josh Norris	R. James Young

VOLUNTEERS

Will Abdo	Cheryl Fowler	Sandra Jones	Bonnie Michael	Patricia Stanfield
Mary Allen	Martin Frazure	Paul Griffin Jones II	James "Jim" Michael	Jayne Stevens
Roger Armstrong	Mary Ellen Garner	Sara Nell Jordan	Mary Morris	Bettye Stewart
Anna Joe Bell	Beverly Gilbert	Phillip Kelly	Robert Muller	David Stricklin
Julie Booth	Edythe Gore	Brantley Martin	Michael Nichols	Billy Thames
Linda Boozer	Debra Harris	Gail Martin	Margie Owens	Kim Tullos
Thomas Cheatham, Jr.	Stacye Hartzog	Richard Mays	Sandra Putnam	Gloria Watkins
Harris Collier	Peggy Horne	Samuel McGee	Martha Robinson	Julian Watson
Carol Druey	Rubie Howell	Lloyd Mcrae	Adam Smith	Charlie Wingard
Jimmie Eidson	Laura Isbell	Hubert Miazza	Gloria Smith	Jeannie Vickers

Learn more about volunteer opportunities at Baptist by calling 601-968-1210.

ON THE DRAWING BOARD FOR 2019

CHAPEL HALL CRITICAL CARE WAITING AREA

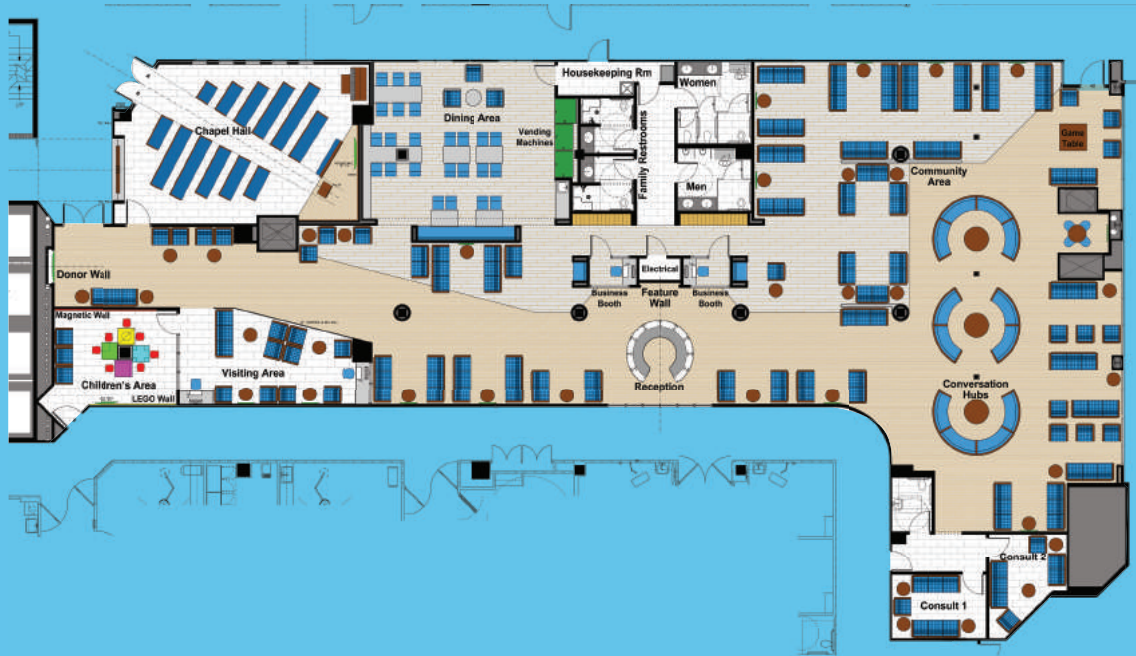

Leading the way with a bold new concept

AN OPPORTUNITY TO BE A PART OF AN EXTRAORDINARY PROJECT

baptisthealth.foundation

1225 N. State Street
Jackson, MS 39202
Phone: 601-968-1489 | Fax: 601-974-6275

Crisler M. Boone
Executive Director
crisler.boone@bmhcc.org

 **BAPTIST** | HEALTH
FOUNDATION